

NOTICE!!

These documents have been scanned!

Do not place un-scanned documents beneath this notice!

Do not remove this notice from this file!

GPO Jacket No. 560-102
Print Order 61540
Rise Business Services, LLC
Job=AZ15 7/15/2019



Box Number= AZ15159



Claim Begin-End: AMC341924-AMC341925

1 Initial Receipt



AZ15159-2

AMC341757-AMC342788

Date Prepared: May 23, 1997

Lead A MC Number: A MC 341924

Ending A MC Number: A MC 341925

CLAIM INDEX

SERIAL NUMBER

CLOSURE DECISION DATE

CLAIM NAME

A MC 341924

MT UNION

A MC 341925

SPRUCE

UNITED STATES
DEPARTMENT OF THE INTERIOR
BUREAU OF LAND MANAGEMENT

RECEIPT AND ACCOUNTING ADVICE

NO. 2264081 04

TC/AZ 11/12/96

Subject: LOCATION & SERVICE FEE 1997 2 6 11 50.00
 Applicant: CLAIM MAINTENANCE FEE 1997 - 2 2 6 12 20.00
 2 6 13 200.00

ANNE COE & ROBERT HORVATH
5776 E FOREST ST
APACHE JUNCTION A 85219

Remitter: CK 4956

ENTERED IN COMPUTER

VERIFIED

JAN 21 1997

MAR 22 1997

Assignor:

LEASE MANAGEMENT DATA									
<input type="checkbox"/> NEW <input type="checkbox"/> UPDATE <input type="checkbox"/> PAYMENT									
ORIGINAL SERIAL NO.	ASG.	TYPE	ST.	CTY.	FUND SYMBOL			ACRES/UNITS	RATE
AMC 341924-341925									
AMOUNT	ANV. DATE	EXP. DATE	BILL CYC.	S/C	DISTRICT	NEXT BILL	MISC. DATA	U of M	ACTUAL UNITS
ASSIGNMENT SERIAL NO.	ASG.	TYPE	ST.	CTY.	FUND SYMBOL			ACRES/UNITS	RATE
AMOUNT	ANV. DATE	EXP. DATE	BILL CYC.	S/C	DISTRICT	NEXT BILL	MISC. DATA	U of M	ACTUAL UNITS

APPLY REMITTANCE

ACTION	FUND SYMBOL	CTY.	AMOUNT
FILING FEE			
RENTAL			
UNEARNED			
REFUND			
TOTAL			
AMOUNT DUE			

Remarks:

BY: _____ DATE: _____

Lease in Escrow?
 KGS?
 Auto Escalates?
 Auto Renew?

Of Interest?
 Operating Rights?
 Operator
 Bond Filed?

FOR MMS USE ONLY		
BILLEE		FOREST REFUGE
NUMBER		
OCS SECTION		
CODE		

UNITED STATES
DEPARTMENT OF THE INTERIOR
BUREAU OF LAND MANAGEMENT

RECEIPT AND ACCOUNTING ADVICE

NO. 2264081 04

TC/AZ 11/12/96

Subject: LOCATION & SERVICE FEE 1997 2 6 11 50.00
 Applicant: CLAIM MAINTENANCE FEE 1997 - 2 2 6 12 20.00
 2 6 13 200.00

ANNE COE & ROBERT HORVATH
5776 E FOREST ST
APACHE JUNCTION A 85219

Remitter: CK 4956

ERS

JB

Assignor:

LEASE MANAGEMENT DATA									
<input type="checkbox"/> NEW <input type="checkbox"/> UPDATE <input type="checkbox"/> PAYMENT									
ORIGINAL SERIAL NO.	ASG.	TYPE	ST.	CTY.	FUND SYMBOL			ACRES/UNITS	RATE
AMC 341924-341925									
AMOUNT	ANV. DATE	EXP. DATE	BILL CYC.	S/C	DISTRICT	NEXT BILL	MISC. DATA	U of M	ACTUAL UNITS
ASSIGNMENT SERIAL NO.	ASG.	TYPE	ST.	CTY.	FUND SYMBOL			ACRES/UNITS	RATE
AMOUNT	ANV. DATE	EXP. DATE	BILL CYC.	S/C	DISTRICT	NEXT BILL	MISC. DATA	U of M	ACTUAL UNITS

APPLY REMITTANCE				Remarks:
ACTION	FUND SYMBOL	CTY.	AMOUNT	
FILING FEE				
RENTAL				
UNEARNED				
REFUND				
TOTAL				
AMOUNT DUE				

BY: _____ DATE: _____

<input type="checkbox"/> Lease in Escrow? <input type="checkbox"/> KGS? <input type="checkbox"/> Auto Escalates? <input type="checkbox"/> Auto Renew?	Of Interest?	FOR MMS USE ONLY	
	Operating Rights?	BILLEE	FOREST REFUGE
	Operator	NUMBER	
	Bond Filed?	OCS SECTION	
		CODE	

NOTICE!!

These documents have been scanned!

Do not place un-scanned documents beneath this notice!

Do not remove this notice from this file!

GPO Jacket No. 560-102
Print Order 61540
Rise Business Services, LLC
Job=AZ15 7/15/2019



Box Number= AZ15159



Claim Begin-End: AMC341924-AMC341925

2 Correspondence



AZ15159-2

AMC341757-AMC342788

**NO
DOCUMENTS
FOUND**

NO DOCUMENTS FOUND
NO DOCUMENTS FOUND

NOTICE!!

These documents have been scanned!

Do not place un-scanned documents beneath this notice!

Do not remove this notice from this file!

GPO Jacket No. 560-102
Print Order 61540
Rise Business Services, LLC
Job=AZ15 7/15/2019



Box Number= AZ15159



Claim Begin-End: AMC341924-AMC341925

3 Transfers



AZ15159-2

AMC341757-AMC342788

24

341924

PREPARED BY:

Ed Elling
17009 N. 58th Way
Scottsdale, Arizona
85254



AFTER RECORDING RETURN TO:

Ed Elling
17009 N. 58th Way
Scottsdale, Arizona
85254

SPACE ABOVE THIS LINE FOR RECORDER'S USE

QUIT CLAIM DEED *EXEMPTION A4*

State of Arizona
Yavapai County

KNOW ALL MEN BY THESE PRESENTS, that for and in consideration of the sum of One Dollar (\$1.00) and/or other valuable consideration to the below in hand paid to:

Anne Coe, a single individual, residing at 5776 E. Forest St., Apache Junction, Arizona, 85119

RECEIVED
BM AZ STATE
2019 FEB 21 10:50
PHOENIX, ARIZONA

The receipt whereof is hereby acknowledged, the undersigned hereby conveys and quitclaims to Ed Elling and Doreen Elling, a married couple, residing at 17009 N. 58th Way, Scottsdale, Arizona, 85254 (hereinafter called the "Grantee(s)") as joint tenants, all the rights, title, interest, and claim in or to the following described real estate, situated in Yavapai County, Arizona, to-wit:

AMC 341924 Claim name MT UNION 20 acres

To have and to hold, the same together with all and singular the appurtenances thereunto belonging or in anywise appertaining, and all the estate, right, title, interest, lien, equity and claim whatsoever for the said first party, either in law or equity, to the only proper use, benefit and behoof of the said second party forever.

Grantor's Signature: *Anne Coe* Date: *10/18/18*

ENTERED
Page 1
MAR 19 2019
BY: *RAM*

Print Name: Anne Coe
Address: 5776 E. Forest Street, Apache Junction, Arizona 85119

State of Arizona ^{JMC}
County of ~~Maricopa~~
Gila

I, the undersigned, a Notary Public in and for said County, in said State, hereby certify that Anne Coe whose names are signed to the foregoing instrument, and who is known to me, acknowledged before me on this day that, being informed of the contents of the instrument, they, executed the same voluntarily on the day the same bears date.

Given under my hand this 18th day of October, 2018.

Jordan N.L. Caldwell
Notary Public (SEAL)

My Commission Expires: 11-29-2021

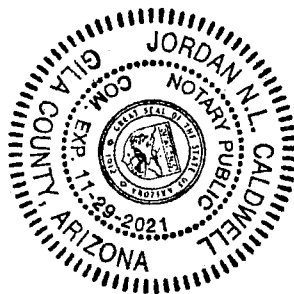

PHOENIX, ARIZONA

2019 FEB 21 P 12:50

RECEIVED
BLM AZ STATE OFFICE

214

PREPARED BY:

Ed Elling
17009 N. 58th Way
Scottsdale, Arizona
85254



AFTER RECORDING RETURN TO:

Ed Elling
17009 N. 58th Way
Scottsdale, Arizona
85254

SPACE ABOVE THIS LINE FOR RECORDER'S USE

QUIT CLAIM DEED

EXEMPTION A4

State of Arizona
Yavapai County

KNOW ALL MEN BY THESE PRESENTS, that for and in consideration of the sum of One-Dollar (\$1.00) and/or other valuable consideration to the below in hand paid to:

Anne Coe, a single individual, residing at 5776 E. Forest St., Apache Junction, Arizona, 85119

The receipt whereof is hereby acknowledged, the undersigned hereby conveys and quitclaims to Ed Elling and Doreen Elling, a married couple, residing at 17009 N. 58th Way, Scottsdale, Arizona, 85254 (hereinafter called the "Grantee(s)") as joint tenants, all the rights, title, interest, and claim in or to the following described real estate, situated in Yavapai County, Arizona, to-wit:

AMC 341925 Claim name SPRUCE 20 Acres

To have and to hold, the same together with all and singular the appurtenances thereunto belonging or in anywise appertaining, and all the estate, right, title, interest, lien, equity and claim whatsoever for the said first party, either in law or equity, to the only proper use, benefit and behoof of the said second party forever.

Grantor's Signature:

Anne Coe

Date:

10/18/18

RECEIVED
BLM A7 STATE OFFICE
2019 FEB 21 P 12:50
PHOENIX, ARIZONA

Print Name: Anne Coe
Address: 5776 E. Forest Street, Apache Junction, Arizona 85119

State of Arizona ^{JNK}
County of ~~Maricopa~~
Gila

I, the undersigned, a Notary Public in and for said County, in said State, hereby certify that Anne Coe whose names are signed to the foregoing instrument, and who is known to me, acknowledged before me on this day that, being informed of the contents of the instrument, they, executed the same voluntarily on the day the same bears date.

Given under my hand this 18th day of October, 2018.

Jordan N. Caldwell
Notary Public

My Commission Expires: 11-29-2021

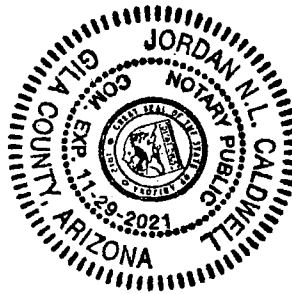

PHOENIX, ARIZONA

2019 FEB 21 P 12:50

RECEIVED
BLM AZ STATE OFFICE

Ed Elling

2-13-19

17009 N. 58th Way

Scottsdale AZ. 85254

RECEIVED
PHOENIX DIST OFFICE

2019 FEB 14 P 1: 38

Hello, please see enclosed Deed Transfer documents. If there are any questions I can be reached at 480-220-4318.

BUREAU OF LAND MGMT
PHOENIX, AZ

Email Hondocabin@yahoo.com

Thank you



RECEIVED
BLM AZ STATE OFFICE
2019 FEB 21 P 12: 50
PHOENIX, ARIZONA

FedEx Express

earthsmart
FedEx carbon-neutral
envelope shipping

RT
8126 02.18
RT 276
ST 9.2
16:30 7
D
8991 02.20

RECEIVED
BLM AZ STATE OFFICE
2019 FEB 21 P 12:20
PHOENIX, ARIZONA

ASHERA ANDERSON (602) 580-5583
BUREAU OF LAND MANAGEMENT
BUREAU OF LAND MANAGEMENT
2185 N 7TH AVE
PHOENIX, AZ 85027
UNITED STATES US

SHIP DATE: 15 FEB 19
ACTWGT: 1.00 LB
CAD: 111661909/NET4100
BILL SENDER

TO TINA COLADONATO
BUREAU OF LAND MANAGEMENT
ONE N CENTRAL ., AVE STE. 800

PHOENIX AZ 85004
(602) 417-9200 REF: DEPT:

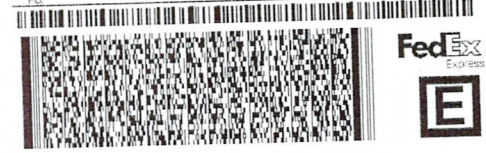

TRK# 7744 7697 8991
WED - 20 FEB 4:30
EXPRESS SAVV
85004
98 ZSYA
AZ-US PHX



United States Department of the Interior

Bureau of Land Management

DIV OF LANDS, MINRLS & ENERGY

ONE N CENTRAL AVE

PHOENIX, AZ 85004 -4427

Phone: 602-417-9200

Receipt

No: 4378929

Transaction #: 4496356	
Date of Transaction: 02/22/2019	
CUSTOMER:	
ED ELLING 17009 N 58TH WAY SCOTTSDALE, AZ 85254-5922 US	

LINE #	QTY	DESCRIPTION	REMARKS	UNIT PRICE	TOTAL
1	1.00	LOCATABLE MINERALS / MINING CLAIMS- NOT NEW-UNADJUD, ONE AUTH NO. ONLY / MINING CLAIM MONEY RECEIVED CASES: AMC341924/\$20.00	TRF/2	- n/a -	20.00
TOTAL:					\$20.00

PAYMENT INFORMATION			
1	AMOUNT:	20.00	POSTMARKED: N/A
	TYPE:	CHECK	RECEIVED: 02/21/2019
	CHECK NO:	2563	
	NAME:	ELLING, ED 17009 N 58TH WAY SCOTTSDALE AZ 85254-5922 US	

REMARKS
THERE HAS BEEN A FEE INCREASE / PLEASE SEE ENCLOSED FLYER / THANK YOU

This receipt was generated by the automated BLM Collections and Billing System and is a paper representation of a portion of the official electronic record contained therein.

United States Department of the Interior
Bureau of Land Management
 DIV OF LANDS, MINRLS & ENERGY
 ONE N CENTRAL AVE
 PHOENIX, AZ 85004 -4427
 Phone: 602-417-9200

Receipt	
No:	4399379

Transaction #: 4517777
Date of Transaction: 03/18/2019

CUSTOMER:	
ED ELLING 17009 N 58TH WAY SCOTTSDALE, AZ 85254-5922 US	

LINE #	QTY	DESCRIPTION	REMARKS	UNIT PRICE	TOTAL
1	1.00	LOCATABLE MINERALS / MINING CLAIMS-NOT NEW-UNADJUD, ONE AUTH NO. ONLY / MINING CLAIM MONEY RECEIVED CASES: AMC341924/\$40.00	UNDER PAYMENT ON QUIT CLAIMS	- n/a -	40.00
TOTAL:					\$40.00

no earned manually AD 3/17/19

PAYMENT INFORMATION

NOTE: Items will appear on credit card statement as "Bureau of Land Mgmt CO".

1	AMOUNT:	40.00	POSTMARKED:	N/A
	TYPE:	CREDIT CARD	RECEIVED:	03/18/2019
	NAME:	ELLING, ED 17009 N 58TH WAY SCOTTSDALE AZ 85254-5922 US		
	CARD NO:	XXXXXXXXXXXX1017	AUTH CODE:	143002
	NAME ON CARD:	EDWARD ELLING		
	SIGNATURE:	OVER THE PHONE		

REMARKS

This receipt was generated by the automated BLM Collections and Billing System and is a paper representation of a portion of the official electronic record contained therein.

United States Department of the Interior
Bureau of Land Management
 DIV OF LANDS, MINRLS & ENERGY
 ONE N CENTRAL AVE
 PHOENIX, AZ 85004 -4427
 Phone: 602-417-9200

Receipt	
No:	4378929

Transaction #: 4496356
Date of Transaction: 02/22/2019

CUSTOMER:	
ED ELLING 17009 N 58TH WAY SCOTTSDALE, AZ 85254-5922 US	

old receipt

LINE #	QTY	DESCRIPTION	REMARKS	UNIT PRICE	TOTAL
1	1.00	LOCATABLE MINERALS / MINING CLAIMS- NOT NEW-UNADJUD, ONE AUTH NO. ONLY / MINING CLAIM MONEY RECEIVED CASES: AMC341924/\$20.00	TRF/2	- n/a -	20.00
TOTAL:					\$20.00

*10 earned manually
AD
3/27/19*

PAYMENT INFORMATION			
1	AMOUNT:	20.00	POSTMARKED: N/A
	TYPE:	CHECK	RECEIVED: 02/21/2019
	CHECK NO:	2563	
	NAME:	ELLING, ED 17009 N 58TH WAY SCOTTSDALE AZ 85254-5922 US	

REMARKS

THERE HAS BEEN A FEE INCREASE / PLEASE SEE ENCLOSED FLYER / THANK YOU

This receipt was generated by the automated BLM Collections and Billing System and is a paper representation of a portion of the official electronic record contained therein.

NOTICE!!

These documents have been scanned!

Do not place un-scanned documents beneath this notice!

Do not remove this notice from this file!

GPO Jacket No. 560-102
Print Order 61540
Rise Business Services, LLC
Job=AZ15 7/15/2019



Box Number= AZ15159



Claim Begin-End: AMC341924-AMC341925

4 Annual Filings



AZ15159-2

AMC341757-AMC342788

DEPARTMENT OF THE INTERIOR
BUREAU OF LAND MANAGEMENT
MINING CLAIMS

Run Date/Time: 9/24/2020

MC Maintenance Fees Paid Through the BLM Pay Portal
(by Date Paid)

Page 1 Of 1

CBS Receipt: 4772034

Printed For Lead File # AMC341924

Agency Tracking ID: 1596143648

Assessment Year: 2021

Number of BLM Serial Nr: 2

Paid On: 7/30/2020

Total Amount Paid:\$330.00

Message: :

Claim Name	BLM Serial No	Lead File No	Amount Paid
MT UNION	AMC341924	AMC341924	\$165.00
SPRUCE	AMC341925	AMC341924	\$165.00

United States Department of the Interior
Bureau of Land Management
 BUSINESS & SUPPORT SVCS DIV
 ONE N CENTRAL AVE SUITE 800
 PHOENIX, AZ 85004 -4427
 Phone: 602-417-9200

Receipt	
No:	4772034

Transaction #: 4898867	
Date of Transaction: 07/30/2020	
CUSTOMER:	
	DOREEN ELLING 17009 N. 58TH WAY SCOTTSDALE, AZ 85254 US

LINE #	QTY	DESCRIPTION	REMARKS	UNIT PRICE	TOTAL
1	1.00	LOCATABLE MINERALS / MINING CLAIMS- NOT NEW-UNADJUD, ONE AUTH NO. ONLY / MINING CLAIM MONEY RECEIVED CASES: AMC341924/\$330.00		- n/a -	330.00
TOTAL:					\$330.00

PAYMENT INFORMATION			
NOTE: Items will appear on credit card statement as "BLM O Mining Claim".			
1	AMOUNT:	330.00	POSTMARKED: N/A
	TYPE:	CREDIT CARD	RECEIVED: 07/30/2020
	NAME:	DOREEN ELLING 17009 N. 58TH WAY SCOTTSDALE AZ 85254 US	
	CARD NO:	XXXXXXXXXXXX2007	AUTH CODE: 285355
	NAME ON CARD:	DOREEN ELLING	
	SIGNATURE:	INTERNET	

REMARKS

This receipt was generated by the automated BLM Collections and Billing System and is a paper representation of a portion of the official electronic record contained therein.

DEPARTMENT OF THE INTERIOR
BUREAU OF LAND MANAGEMENT
MINING CLAIMS

Run Date/Time: 8/6/2019

MC Maintenance Fees Paid Through the BLM Pay Portal
(by Date Paid)

Page 15 Of 102

CBS Receipt: 4505167

Printed For Lead File # AMC341924

Agency Tracking ID: 1562779656

Assessment Year: 2020

Number of BLM Serial Nr: 2

Paid On: 7/10/2019

Total Amount Paid: \$330.00

Claim Name	BLM Serial No	Lead File No	Amount Paid
MT UNION	AMC341924	AMC341924	\$165.00
SPRUCE	AMC341925	AMC341924	\$165.00

**United States Department of the Interior
Bureau of Land Management
BUSINESS & SUPPORT SVCS DIV
ONE N CENTRAL AVE SUITE 800
PHOENIX, AZ 85004 -4427
Phone: 602-417-9200**

Receipt

No: 4505167

Transaction #: 4625571	
Date of Transaction: 07/10/2019	
CUSTOMER:	
DOREEN J ELLING 17009 N. 58TH WAY SCOTTSDALE, AZ 85254 US	

LINE #	QTY	DESCRIPTION	REMARKS	UNIT PRICE	TOTAL
1	1.00	LOCATABLE MINERALS / MINING CLAIMS- NOT NEW-UNADJUD, ONE AUTH NO. ONLY / MINING CLAIM MONEY RECEIVED CASES: AMC341924/\$330.00		- n/a -	330.00
TOTAL:					\$330.00

PAYMENT INFORMATION			
NOTE: Items will appear on credit card statement as "BLM O Mining Claim".			
1	AMOUNT:	330.00	POSTMARKED: N/A
	TYPE:	CREDIT CARD	RECEIVED: 07/10/2019
	NAME:	DOREEN J ELLING 17009 N. 58TH WAY SCOTTSDALE AZ 85254 US	
	CARD NO:	XXXXXXXXXXXX1009	AUTH CODE: 213758
	NAME ON CARD:	DOREEN J ELLING	
	SIGNATURE:	INTERNET	

REMARKS

This receipt was generated by the automated BLM Collections and Billing System and is a paper representation of a portion of the official electronic record contained therein.

341924

Anne Coe 5776 E. Forest St.
Apache Junction, AZ 85119

JULY 23, 2018

United States Department of the Interior
Bureau of Land Management
LANDS/RECREATION & PLANNING
ONE N CENTRAL AVE, SUITE 800
PHOENIX, AZ 85004-4427

Enclosed please find my payment of \$310.00 for the following
Mining claims.

AMC 341924 MT UNION
AMC 341925 SPRUCE

Sincerely,

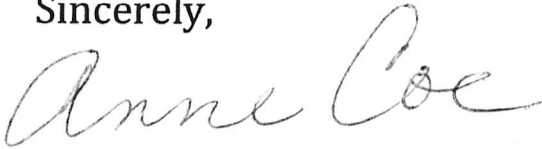

Anne Coe

RECEIVED
BLM AZ STATE OFFICE
2018 JUL 24 P 2:56
PHOENIX, ARIZONA

ENTERED
JUL 31 2018
BY: RAM

4219422

ANNIE COE
5776 E FOREST ST
APACHE JUNCTION
AZ 85119

PHOENIX AZ 852

23 JUL 2018 PM 5 L



RECEIVED
BLM AZ STATE OFFICE

2018 JUL 24 P 2:50

PHOENIX, ARIZONA

UNITED STATES DEPT OF INTERIOR
BUREAU OF LAND MANAGEMENT
LANDS/RECREATION & PLANNING
ONE N CENTRAL AVE, SUITE 800
PHOENIX, AZ 85004-4427

85004-442700



United States Department of the Interior
Bureau of Land Management
 DIV OF LANDS, MINRLS & ENERGY
 ONE N CENTRAL AVE
 PHOENIX, AZ 85004 -4427
 Phone: 602-417-9200

Receipt

No: 4219422

Transaction #: 4334607	
Date of Transaction: 07/25/2018	
CUSTOMER:	
ANNE E COE 5776 E FOREST ST APACHE JUNCTION, AZ 85119-9506 US	

LINE #	QTY	DESCRIPTION	REMARKS	UNIT PRICE	TOTAL
1	1.00	LOCATABLE MINERALS / MINING CLAIMS- NOT NEW-UNADJUD, ONE AUTH NO. ONLY / MINING CLAIM MONEY RECEIVED CASES: AMC341924/\$310.00	MAINT 2019/2	- n/a -	310.00
TOTAL:					\$310.00

PAYMENT INFORMATION			
1	AMOUNT:	310.00	POSTMARKED: N/A
	TYPE:	CHECK	RECEIVED: 07/24/2018
	CHECK NO:	1003	
	NAME:	COE, ANNE E 5776 E FOREST ST APACHE JUNCTION AZ 85119-9506 US	

REMARKS

This receipt was generated by the automated BLM Collections and Billing System and is a paper representation of a portion of the official electronic record contained therein.

341924

Anne Coe 5776 E. Forest St.
Apache Junction, AZ 85119

August 14, 2017

United States Department of the Interior
Bureau of Land Management
LANDS/RECREATION & PLANNING
ONE N CENTRAL AVE, SUITE 800
PHOENIX, AZ 85004-4427

RECEIVED
2017 AUG 16 P 2:51
PHOENIX, ARIZONA

Enclosed please find my payment of \$310.00 for the following Mining claims.

AMC 341924 MT UNION
AMC 341925 SPRUCE

Sincerely,

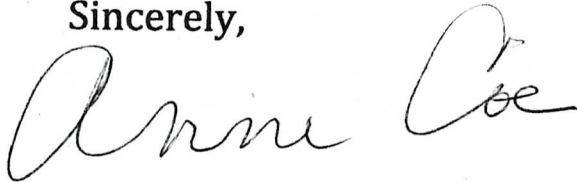

Anne Coe

3942041

ENTERED
AUG 21 2017
BY: *Ann*

ANNE COE
5776 E. FOREST ST
APACHE JUNCTION, AZ
85719

PHOENIX AZ 852

15 AUG 2017 PM 4 L

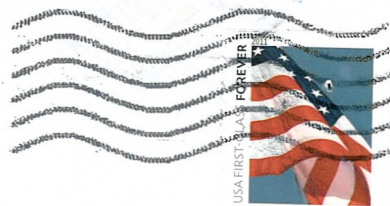

RECEIVED
BLM AZ STATE OFFICE
2017 AUG 16 P 2:51
PHOENIX, ARIZONA

UNITED STATES DEPARTMENT OF THE INTERIOR
BUREAU OF LAND MANAGEMENT
LANDS/RECREATION & PLANNING
ONE N CENTRAL AVE, SUITE 800
PHOENIX, AZ 85004-4427

85004-442700



United States Department of the Interior
Bureau of Land Management
 DIV OF LANDS, MINRLS & ENERGY
 ONE N CENTRAL AVE
 PHOENIX, AZ 85004 -4427
 Phone: 602-417-9200

Receipt

No: 3942041

Transaction #: 4051712	
Date of Transaction: 08/17/2017	
CUSTOMER:	
ANNE E COE 5776 E FOREST ST APACHE JUNCTION, AZ 85119-9506 US	

LINE #	QTY	DESCRIPTION	REMARKS	UNIT PRICE	TOTAL
1	1.00	LOCATABLE MINERALS / MINING CLAIMS- NOT NEW-UNADJUD, ONE AUTH NO. ONLY / MINING CLAIM MONEY RECEIVED CASES: AMC341924/\$310.00	MAINT 2018/2	- n/a -	310.00
TOTAL:					\$310.00

PAYMENT INFORMATION			
1	AMOUNT:	310.00	POSTMARKED: 08/15/2017
	TYPE:	CHECK	RECEIVED: 08/16/2017
	CHECK NO:	294	
	NAME:	COE, ANNE E 5776 E FOREST ST APACHE JUNCTION AZ 85119-9506 US	

REMARKS

This receipt was generated by the automated BLM Collections and Billing System and is a paper representation of a portion of the official electronic record contained therein.

341924

Anne Coe 5776 E. Forest St.
Apache Junction, AZ 85119

RECEIVED
BLM AZ STATE OFFICE

2016 AUG 16 P 1:25

PHOENIX, ARIZONA

August 14, 2016

United States Department of the Interior
Bureau of Land Management
ONE N CENTRAL AVE, SUITE 800
PHOENIX, AZ 85004-4427

Enclosed please find my payment of \$310.00 for the following
Mining claims.

AMC 341924 MT UNION
AMC 341925 SPRUCE

Sincerely,



Anne Coe

RECEIPT # 3633060

ANNE COE
5776 E. FOREST ST
APACHE JUNCTION, AZ
85119

PHOENIX, AZ 852

15 AUG 2016 PM 8 L



RECEIVED
BLM AZ STATE OFFICE
2016 AUG 16 P 1:25
PHOENIX, ARIZONA

UNITED STATES DEPARTMENT OF THE INTERIOR
BUREAU OF LAND MANAGEMENT
ONE N CENTRAL AVE, SUITE 800
PHOENIX, AZ 85004-4427

Att: Mining Claims

85004-442700



United States Department of the Interior
Bureau of Land Management
 DIV OF LANDS, MINRLS & ENERGY
 ONE N CENTRAL AVE
 PHOENIX, AZ 85004 -4427
 Phone: 602-417-9200

Receipt

No: 3633060

Transaction #: 3736878	
Date of Transaction: 08/17/2016	
CUSTOMER:	
ANNE E COE 5776 E FOREST ST APACHE JUNCTION, AZ 85119-9506 US	

LINE #	QTY	DESCRIPTION	REMARKS	UNIT PRICE	TOTAL
1	1.00	LOCATABLE MINERALS / MINING CLAIMS- NOT NEW-UNADJUD, ONE AUTH NO. ONLY / MINING CLAIM MONEY RECEIVED CASES: AMC341924/\$310.00	MAINT FEE 2017 - 2	- n/a -	310.00
TOTAL:					\$310.00

PAYMENT INFORMATION					
1	AMOUNT:	310.00	POSTMARKED:	08/15/2016	
	TYPE:	CHECK	RECEIVED:	08/16/2016	
	CHECK NO:	288			
	NAME:	COE, ANNE E 5776 E FOREST ST APACHE JUNCTION AZ 85119-9506 US			

REMARKS

This receipt was generated by the automated BLM Collections and Billing System and is a paper representation of a portion of the official electronic record contained therein.

ENTERED
 AUG 23 2016
 BY: *ob*

341924

Anne Coe
5776 E. Forest Rd.
Apache Junction, AZ 85219 480.982.0473
anne@annecoe.com www.annecoe.com

August 10, 2015

Bureau of Land Management
US Dept of Interior
Business and Support SVCS DIV
One N. Central Ave Suite 800
Phoenix, AZ 85004-4427

Enclosed please find payment of \$310.00 for the following mining claims:

AMC 341924 Mt. Union
AMC 341925 Spruce

Sincerely,

Anne Coe

RECEIVED
BLM APACHE JUNCTION OFFICE
2015 AUG 12 P 3:35
PHOENIX, ARIZONA

RECEIPT # 3366388

ENTERED
AUG 18 2015
BY: JE



Anne Coe
5776 E. Forest St.
Apache Jct, AZ 85119-9506

PHOENIX AZ 852

10 AUG 2015 PM 6 L

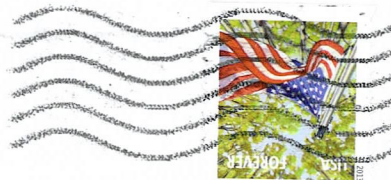

RECEIVED
BLM AZ STATE OFFICE

2015 AUG 12 P 2:24

PHOENIX, ARIZONA

Bureau of Land Mgmt
One N. Central Suite 800
Phoenix, AZ. 85004-4427

SVCS DIV

85004441499

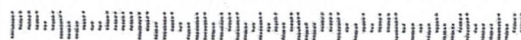

United States Department of the Interior
Bureau of Land Management
LANDS/RECREATION & PLANNING
ONE N CENTRAL AVE
PHOENIX, AZ 85004 -2203
Phone: 602-417-9200

Receipt

No: 3366388

Transaction #: 3464463	
Date of Transaction: 08/13/2015	
CUSTOMER:	
ANNE E COE 5776 E FOREST ST APACHE JUNCTION, AZ 85119-9506 US	

LINE #	QTY	DESCRIPTION	REMARKS	UNIT PRICE	TOTAL
1	1.00	LOCATABLE MINERALS / MINING CLAIMS- NOT NEW-UNADJUD, ONE AUTH NO. ONLY / MINING CLAIM MONEY RECEIVED CASES: AMC341924/\$310.00	MAINT FEE PYMNT (2) 2016	- n/a -	310.00
TOTAL:					\$310.00

PAYMENT INFORMATION			
1	AMOUNT:	310.00	POSTMARKED: 08/10/2015
	TYPE:	CHECK	RECEIVED: 08/12/2015
	CHECK NO:	284	
	NAME:	COE, ANNE E 5776 E FOREST ST APACHE JUNCTION AZ 85119-9506 US	

REMARKS

This receipt was generated by the automated BLM Collections and Billing System and is a paper representation of a portion of the official electronic record contained therein.

Amc 341924

Anne Coe
5776 E. Forest Rd.
Apache Junction, AZ 85219 480.982.0473
anne@annecoe.com www.annecoe.com

August 4, 2014

Bureau of Land Management
US Dept of Interior
Business and Support SVCS DIV
One N. Central Ave Suite 800
Phoenix, AZ 85004-4427

Enclosed please find payment of \$310.00 for the following mining claims:

AMC 341924 Mt. Union
AMC 341925 Spruce

Sincerely,



Anne Coe

RECEIVED
BLM AZ STATE OFFICE
2014 AUG 18 P 2:46
PHOENIX, ARIZONA

NO. OF CLAIMS 2
AMOUNT \$310.00
RECEIPT NO. 3105522
INIT. ASA
** BLM-ASO**

ENTERED
AUG 21 2014
BY RAM

ANNE COE
5776 E. FOREST ST.
APACHE JUNCTION, AZ
85119

RECEIVED
BLM AZ STATE OFFICE

2014 AUG 18 P 2:46

PHOENIX, ARIZONA

PHOENIX AZ 852

15 AUG 2014 PM 10 L



BUREAU OF LAND MANAGEMENT
US DEPT OF INTERIOR
BUSINESS AND SUPPORT SVCS DIV
ONE N. CENTRAL AVE 85004-4427

85004X4414



United States Department of the Interior
Bureau of Land Management
 LANDS/RECREATION & PLANNING
 ONE N CENTRAL AVE
 PHOENIX, AZ 85004 -2203
 Phone: 602-417-9200



Receipt

No: 3105522

Transaction #: 3197174	
Date of Transaction: 08/19/2014	
CUSTOMER:	
ANNE E COE 5776 E FOREST ST APACHE JUNCTION, AZ 85119-9506 US	

LINE #	QTY	DESCRIPTION	REMARKS	UNIT PRICE	TOTAL
1	1.00	LOCATABLE MINERALS / MINING CLAIMS- NOT NEW-UNADJUD, ONE AUTH NO. ONLY / MINING CLAIM MONEY RECEIVED CASES: AMC341924/\$310.00	MAINT FEE PYMNT (2) 2015	- n/a -	310.00
TOTAL:					\$310.00

PAYMENT INFORMATION					
1	AMOUNT:	310.00	POSTMARKED:	08/15/2014	
	TYPE:	CHECK	RECEIVED:	08/18/2014	
	CHECK NO:	269			
	NAME:	COE, ANNE E 5776 E FOREST ST APACHE JUNCTION AZ 85119-9506 US			

REMARKS

This receipt was generated by the automated BLM Collections and Billing System and is a paper representation of a portion of the official electronic record contained therein.

341924

Anne Coe
5776 E. Forest Rd.
Apache Junction, AZ 85219 480.982.0473
anne@annecoe.com www.annecoe.com

August 4, 2013

Bureau of Land Management
US Dept of Interior
Business and Support SVCS DIV
One N. Central Ave Suite 800
Phoenix, AZ 85004-4427

Enclosed please find payment of \$280.00 for the following mining claim

AMC 341924 Mt. Union
AMC 341925 Spruce

Sincerely,

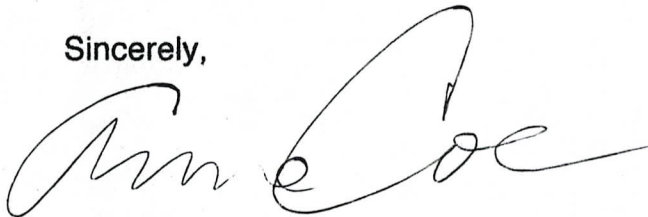

Anne Coe

RECEIVED
BLM AZ STATE OFFICE
2013 AUG -7 AM 11:50
PHOENIX, ARIZONA

NO. OF CLAIMS 2
AMOUNT \$280.00
RECEIPT NO. 2800000
INIT. AC

** BLM-ASO**

ENTERED COMPUTER

RE 8-19-13

Coe
5776 E Forest St
AZ, AZ 85119

RECEIVED
BLM AZ STATE OFFICE

2013 AUG -7 AM 11:50

PHOENIX, ARIZONA

Bureau of Land Management
Business Support SVCS DIV
One Central Ave Suite 800
Phoenix, AZ 85004
85004-4427



First-Class Mail
Postage & Fees Paid
USPS
Permit No. G-10

RECEIVED
BLM AZ STATE OFFICE
2013 AUG -7 AM 11: 50
PHOENIX, ARIZONA



WE CARE

US Postal Service

DEAR VALUED POSTAL CUSTOMER:

I want to extend my sincere apology as your Postmaster for the enclosed document that was inadvertently damaged in handling by your Postal Service.

We are aware how important your mail is to you. With that in mind, we are forwarding it to you in an expeditious fashion.

The United States Postal Service handles over 202 billion pieces of mail each year. While each employee makes a concerted effort to process, without damage, each piece of mail, an occasional mishap does happen.

We are constantly working to improve our processing methods so that these incidents will be eliminated. You can help us greatly in our efforts if you will continue to properly prepare and address each letter or parcel that you enter into the mailstream.

We appreciate your cooperation and understanding and sincerely regret any inconvenience that you have experienced.

YOUR POSTMASTER

United States Department of the Interior
Bureau of Land Management
 LANDS/RECREATION & PLANNING
 ONE N CENTRAL AVE
 PHOENIX, AZ 85004 -2203
 Phone: 602-417-9200

Receipt

No: 2850000

Transaction #: 2935717	
Date of Transaction: 08/08/2013	
CUSTOMER:	
	ANNE E COE 5776 E FOREST ST APACHE JUNCTION, AZ 85219-9506 US

LINE #	QTY	DESCRIPTION	REMARKS	UNIT PRICE	TOTAL
1	1.00	LOCATABLE MINERALS / MINING CLAIMS- NOT NEW-UNADJUD, ONE AUTH NO. ONLY / MINING CLAIM MONEY RECEIVED CASES: AMC341924/\$280.00	MAINT FEE PYMNT (2) 2014	- n/a -	280.00
TOTAL:					\$280.00

PAYMENT INFORMATION					
1	AMOUNT:	280.00	POSTMARKED:	08/06/2013	
	TYPE:	CHECK	RECEIVED:	08/07/2013	
	CHECK NO:	259			
	NAME:	COE, ANNE E 5776 E FOREST ST APACHE JUNCTION AZ 85219-9506 US			

REMARKS

This receipt was generated by the automated BLM Collections and Billing System and is a paper representation of a portion of the official electronic record contained therein.

Anne Coe 5776 E. Forest Rd.
Apache Junction, AZ 8511

AMC 341924

August 1, 2012

Bureau of Land Management
US Dept of Agriculture
Business and Support SVCS DIV
One Central Ave Suite 800
Phoenix, AZ 85004-4427

Enclosed please find my payment of \$280.00 for the following
mining claims.

AMC 341924 MT UNION
AMC 341925 SPRUCE

Sincerely,

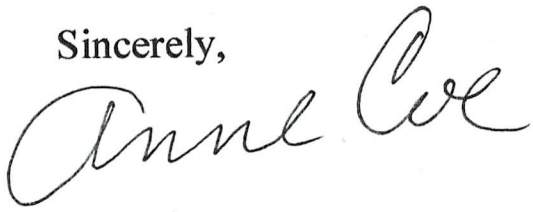

Anne Coe

RECEIVED
PLM AZ STATE OFFICE
2012 AUG 16 A 11:13
PHOENIX, ARIZONA

NO. OF CLAIMS 2
AMOUNT \$280.00
RECEIPT NO. 2633006
INIT. A.C.
** RIM-ASO**

ENTERED IN COMPUTER

RE 8-24-12

Cal
5776 E Forest
WJ., AZ. 85119

14 AUG 2012 PM 8 L

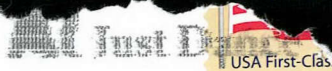

RECEIVED
BLM AZ STATE OFFICE
2012 AUG 16 A 10:59
PHOENIX, ARIZONA
Bureau of Land Mgmt.
Business Support SUCS DIV
One Central Ave. Suite 800
Phx, AZ. 85004-4427

Mining Claims

85004442700



Coe
5776 E Forest
Av., AZ. 85119

14 AUG 2012 PM 8 L

Just Done



RECEIVED
BLM AZ STATE OFFICE
2012 AUG 16 A 10:59
PHOENIX, ARIZONA
Bureau of Land Mgmt.
Business Support SUCS DIV
One Central Ave. Suite 800
Phx, AZ. 85004-4427

Mining Claims

85004442700

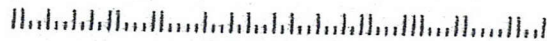

United States Department of the Interior
Bureau of Land Management
 LANDS/RECREATION & PLANNING
 ONE N CENTRAL AVE
 PHOENIX, AZ 85004 -2203
 Phone: 602-417-9200

Receipt

No: 2633006

Transaction #: 2713542	
Date of Transaction: 08/17/2012	
CUSTOMER:	
ANNE E COE 5776 E FOREST ST APACHE JUNCTION, AZ 85219-9506 US	

LINE #	QTY	DESCRIPTION	REMARKS	UNIT PRICE	TOTAL
1	1.00	LOCATABLE MINERALS / MINING CLAIMS-NOT NEW-UNADJUD, ONE AUTH NO. ONLY / MINING CLAIM MONEY RECEIVED CASES: AMC341924/\$280.00	MAINT FEE PYMNT (2) 2013	- n/a -	280.00
TOTAL:					\$280.00

PAYMENT INFORMATION			
1	AMOUNT:	280.00	POSTMARKED: N/A
	TYPE:	CHECK	RECEIVED: 08/16/2012
	CHECK NO:	139	
	NAME:	COE, ANNE E 5776 E FOREST ST APACHE JUNCTION AZ 85219-9506 US	

REMARKS

This receipt was generated by the automated BLM Collections and Billing System and is a paper representation of a portion of the official electronic record contained therein.

Amc 341 924

Anne Coe 5776 E. Forest Rd.
Apache Junction, AZ 8511

August 1, 2011

Bureau of Land Management
US Dept of Agriculture
Business and Support SVCS DIV
One Central Ave Suite 800
Phoenix, AZ 85004-4427

Enclosed please find my payment of \$280.00 for the following
mining claims.

AMC 341924 MT UNION
AMC 341925 SPRUCE

Sincerely,

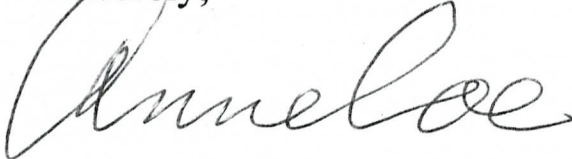

Anne Coe

RECEIVED
BLM AZ STATE OFFICE
2011 AUG -11 A 8:21
PHOENIX, ARIZONA

NO. OF CLAIMS 2
AMOUNT 280.00
RECEIPT NO. 23916102
INIT. SPJ
** BLM-ASO**

United States Department of the Interior
 Bureau of Land Management
 LANDS/RECREATION & PLANNING
 ONE N CENTRAL AVE
 PHOENIX, AZ 85004 -2203
 Phone: 602-417-9200

Receipt

No: 2396721

Transaction #: 2471855	
Date of Transaction: 08/04/2011	
CUSTOMER:	
ANNE E COE 5776 E FOREST ST APACHE JUNCTION, AZ 85219-9506 US	

LINE #	QTY	DESCRIPTION	REMARKS	UNIT PRICE	TOTAL
1	1.00	LOCATABLE MINERALS / MINING CLAIMS-NOT NEW-UNADJUD, ONE AUTH NO. ONLY / MINING CLAIM MONEY RECEIVED CASES: AMC341924/\$280.00	MAINT-2	- n/a -	280.00
TOTAL:					\$280.00

PAYMENT INFORMATION					
1	AMOUNT:	280.00	POSTMARKED:	08/02/2011	
	TYPE:	CHECK	RECEIVED:	08/04/2011	
	CHECK NO:	101			
	NAME:	COE, ANNE E 5776 E FOREST ST APACHE JUNCTION AZ 85219-9506 US			

REMARKS

This receipt was generated by the automated BLM Collections and Billing System and is a paper representation of a portion of the official electronic record contained therein.

Sid Griest
5776 E. Forest St.
Apache Junction, AZ
85119

PHOENIX AZ 850

02 AUG 2011 PM 11 L



RECEIVED
BLM AZ STATE OFFICE

2011 AUG -3 P 2:07

PHOENIX, ARIZONA

BUREAU OF LAND MANAGEMENT
US DEPT OF AGRICULTURE
BUSINESS AND SUPPORT SVCS DIV
ONE CENTRAL AVE, SUITE 800
PHOENIX, AZ 85004-4427

850044427



USA First-Class Forever

AMC 341924

1041

ANNE E. COE
5776 E FOREST ST
APACHE JUNCTION, AZ 85219
(480) 982-0473

WELLS FARGO BANK ARIZONA, NA
526 S. MILL AVE.
TEMPE, AZ 85281
91-527/1221

Aug 4, 2010

PAY TO THE
ORDER OF

Bureau of Land Mgt

\$ 280⁰⁰

two hundred eighty and

00

DOLLARS

100

MEMO

Spruce + Millner

Anne Coe

AMC 341924

AMC 341925

ENTERED INTO COMPUTER

AUG 19 2010

PHOENIX, ARIZONA

2010 AUG 12 A 10: 28

RECEIVED
BLM AZ STATE OFFICE

NO. OF CLAIMS

2

AMOUNT

\$ 280.00

RECEIPT NO.

2189372

INIT.

AKH

** BLM-ASO **

United States Department of the Interior
Bureau of Land Management
 LANDS/RECREATION & PLANNING
 ONE N CENTRAL AVE
 PHOENIX, AZ 85004 -2203
 Phone:

Receipt

No: 2189372

Transaction #: 2259087		ENTERED INTO COMPUTER AUG 19 2010
Date of Transaction: 08/12/2010		
CUSTOMER:	ANNE E COE 5776 E FOREST ST APACHE JUNCTION, AZ 85219-9506 US	

LINE #	QTY	DESCRIPTION	REMARKS	UNIT PRICE	TOTAL
1	1.00	LOCATABLE MINERALS / MINING CLAIMS- NOT NEW-UNADJUD, ONE AUTH NO. ONLY / MINING CLAIM MONEY RECEIVED CASES: AMC341924/\$280.00	MAINT FEE PYMNT (2) 2011	- n/a -	280.00
TOTAL:					\$280.00

PAYMENT INFORMATION					
1	AMOUNT:	280.00	POSTMARKED:	08/03/2010	
	TYPE:	CHECK	RECEIVED:	08/10/2010	
	CHECK NO:	1041			
	NAME:	COE, ANNE 5776 E FOREST ST APACHE JUNCTION AZ 85219-9506 US			

REMARKS	

This receipt was generated by the automated BLM Collections and Billing System and is a paper representation of a portion of the official electronic record contained therein.

AMC 341924

Anne Coe
5776 E. Forest Rd.
Apache Junction, AZ 85219 480.982.0473
anne@annecoe.com www.annecoe.com

August 21, 2009

Bureau of Land Management
US Dept of Interior
Business and Support SVCS DIV
One N. Central Ave Suite 800
Phoenix, AZ 85004-4427

Enclosed please find payment for the following mining claims:

AMC 341924 Mt. Union ✓
AMC 341925 Spruce

Sincerely,



Anne Coe

PHOENIX, ARIZONA

2009 AUG 26 A 7:43

RECEIVED
BLM AZ STATE OFFICE



United States Department of the Interior
Bureau of Land Management
 BUSINESS & SUPPORT SVCS DIV
 ONE N CENTRAL AVE SUITE 800
 PHOENIX, AZ 85004 -4427
 Phone: (602) 417-9200

Receipt

No: 1987554

Transaction #: 2051728	
Date of Transaction: 08/26/2009	
CUSTOMER:	ANNE E COE 5776 E FOREST ST APACHE JUNCTION, AZ 85219-9506 US

LINE #	QTY	DESCRIPTION	REMARKS	UNIT PRICE	TOTAL
1	1.00	LOCATABLE MINERALS / MINING CLAIMS-NOT NEW-UNADJUD, ONE AUTH NO. ONLY / MINING CLAIM MONEY RECEIVED CASES: AMC341924/\$280.00	MAINT 2010	- n/a -	280.00
TOTAL:					\$280.00

PAYMENT INFORMATION					
1	AMOUNT:	280.00	POSTMARKED:	08/24/2009	
	TYPE:	CHECK	RECEIVED:	08/26/2009	
	CHECK NO:	1040			
	NAME:	COE, ANNE E 5776 E FOREST ST APACHE JUNCTION AZ 85219-9506 US			

REMARKS

This receipt was generated by the automated BLM Collections and Billing System and is a paper representation of a portion of the official electronic record contained therein.

Amc 341924

Anne Coe
5776 E. Forest Rd.
Apache Junction, AZ 85219 480.982.0473
anne@annecoe.com www.annecoe.com

Bureau of Land Mgt
One N. Central Ave
Phoenix, AZ 84004-2203

Please find enclosed my check for \$250.00 fir tge following mining claims:

AMC 341924 MT UNION

AMC 341925 SPRUCE

ENTERED INTO COMPUTER

SEP 04 2008

RB

Anne Coe



PHOENIX, ARIZONA

2008 AUG 13 A 7: 16

RECEIVED
B.L.M. AZ STATE OFFICE

United States Department of the Interior

Bureau of Land Management
 BUSINESS & SUPPORT SVCS DIV
 ONE N CENTRAL AVE SUITE 800
 PHOENIX, AZ 85004 -4427
 Phone: (602) 417-9200

Receipt

No:

1760473

Transaction #: 1817978		ENTERED INTO COMPUTER
Date of Transaction: 08/13/2008		
CUSTOMER:	ANNE COE 5776 E FOREST ST APACHE JUNCTION, AZ 85219	SEP 04 2008 <i>PB & VERIFIED</i>

LINE #	QTY	DESCRIPTION	REMARKS	UNIT PRICE	TOTAL
1	1.00	LOCATABLE MINERALS / MINING CLAIMS-NOT NEW-UNADJUD, ONE AUTH NO. ONLY / MINING CLAIM MONEY RECEIVED (455) CASES: AMC341924/\$250.00	MAINT 2009	- n/a -	250.00
TOTAL:					\$250.00

PAYMENT INFORMATION					
1	AMOUNT:	\$250.00	POSTMARKED:	8/11/08 0:00	
	TYPE:	CHECK	RECEIVED:	08/13/2008	
	CHECK NO:	0586			
	NAME:	COE, ANNE E 5776 E FOREST ST APACHE JUNCTION AZ 85219			

REMARKS

This receipt was generated by the automated BLM Collections and Billing System and is a paper representation of a portion of the official electronic record contained therein.

AMC 341924

Anne Coe
5776 E. Forest Rd.
Apache Junction, AZ 85219 480.982.0473
anne@annecoe.com www.annecoe.com

August 10, 2007

Bureau of Land Management
US Dept of Interior
Business and Support SVCS DIV
One N. Central Ave
Phoenix, AZ 85004-2203

Enclosed please find payment for the following mining claims:

AMC 341924 Mt. Union
AMC 341925 Spruce

Sincerely,



Anne Coe

RECEIVED
B.L.M. AZ STATE OFFICE
2007 AUG 14 A 9:34
PHOENIX, ARIZONA

ENTERED INTO COMPUTER
8/17/07 Dgg

United States Department of the Interior
 Bureau of Land Management
 BUSINESS & SUPPORT SVCS DIV
 ONE N CENTRAL AVE SUITE 800
 PHOENIX, AZ 85004 -4427
 Phone: (602) 417-9200

Receipt

No: 1544771

Transaction #: 1596149	
Date of Transaction: 08/15/2007	
CUSTOMER:	ANNE COE 5776 E FOREST ST APACHE JUNCTION, AZ 85219

LINE #	QTY	DESCRIPTION	REMARKS	UNIT PRICE	TOTAL
1	1.00	LOCATABLE MINERALS / MINING CLAIMS-NOT NEW-UNADJUD, ONE AUTH NO. ONLY / MINING CLAIM MONEY RECEIVED (455) CASES: AMC341924/\$250.00	MAINT 2008 (2)	- n/a -	250.00
TOTAL:					\$250.00

PAYMENT INFORMATION					
1	AMOUNT:	\$250.00	POSTMARKED:	8/11/07 0:00	
	TYPE:	CHECK	RECEIVED:	08/14/2007	
	CHECK NO:	0961			
	NAME:	COE, ANNE E 5776 E FOREST ST APACHE JUNCTION AZ 85219			

REMARKS

This receipt was generated by the automated BLM Collections and Billing System and is a paper representation of a portion of the official electronic record contained therein.

Amc 341924

United States Department of the Interior
Bureau of Land Management
 BUSINESS & SUPPORT SVCS DIV
 ONE N CENTRAL AVE
 PHOENIX, AZ 85004 -2203
 Phone: (602) 417-9200

Receipt

No: 1347195

Transaction #: 1392469	
Date of Transaction: 08/29/2006	
CUSTOMER:	ANNE COE 5776 E FOREST ST APACHE JUNCTION, AZ 85219

LINE #	QTY	DESCRIPTION	REMARKS	UNIT PRICE	TOTAL
1	1.00	LOCATABLE MINERALS / MINING CLAIMS- NOT NEW-UNADJUD, ONE AUTH NO. ONLY / MINING CLAIM MONEY RECEIVED (455) CASES: AMC341924/\$250.00	MAINT 2007 (2)	- n/a -	250.00
TOTAL:					\$250.00

PAYMENT INFORMATION			
1	AMOUNT:	\$250.00	POSTMARKED: 08/25/2006
	TYPE:	CHECK	RECEIVED: 08/29/2006
	CHECK NO:	0902	
	NAME:	COE, ANNE E 5776 E FOREST ST APACHE JUNCTION AZ 85219	

REMARKS

This receipt was generated by the automated BLM Collections and Billing System and is a paper representation of a portion of the official electronic record contained therein.

ENTERED INTO COMPUTER
 9/6/06 AB

Anne Coe
5776 E. Forest Rd.
Apache Junction, AZ 85219 480.982.0473
anne@annecoe.com www.annecoe.com

Bureau of Land Management
222 N. Central Ave.
Phoenix, AZ 85004-2003

RECEIVED
B.L.M. AZ STATE OFFICE
2006 AUG 28 A 10: 00
PHOENIX, ARIZONA

Please find enclosed my check for \$250 for the following mining claims.

AMC 341924 Mt Union

AMC 341925 Spruce

Sincerely,

Anne Coe

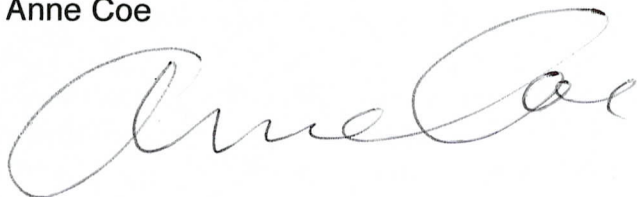

Receipt # 1347195

AMC 341925

ENTERED IN COMPUTER

motyde

Anne Coe

5776 E. Forest Rd.

Apache Junction, AZ 85219 480.982.0473

anne@annecoe.com www.annecoe.com

Bureau of Land Management
222 N. Central Ave.
Phoenix, AZ 85004-2003

PHOENIX, ARIZONA

2006 AUG 29 A 10: 08

RECEIVED
B.L.M. AZ STATE OFFICE

Please find enclosed my check for \$250 for the following mining claims.

AMC 341924 Mt Union

AMC 341925 Spruce

Sincerely,

Anne Coe



United States Department of the Interior
Bureau of Land Management
 BUSINESS & SUPPORT SVCS DIV
 ONE N CENTRAL AVE
 PHOENIX, AZ 85004 -2203
 Phone: (602) 417-9200

Receipt

No: 1347195

Transaction #: 1392469	
Date of Transaction: 08/29/2006	
CUSTOMER:	ANNE COE 5776 E FOREST ST APACHE JUNCTION, AZ 85219

LINE #	QTY	DESCRIPTION	REMARKS	UNIT PRICE	TOTAL
1	1.00	LOCATABLE MINERALS / MINING CLAIMS- NOT NEW-UNADJUD, ONE AUTH NO. ONLY / MINING CLAIM MONEY RECEIVED (455) CASES: AMC341924/\$250.00	MAINT 2007 (2)	- n/a -	250.00
TOTAL:					\$250.00

PAYMENT INFORMATION			
1	AMOUNT:	\$250.00	POSTMARKED: 08/25/2006
	TYPE:	CHECK	RECEIVED: 08/29/2006
	CHECK NO:	0902	
	NAME:	COE, ANNE E 5776 E FOREST ST APACHE JUNCTION AZ 85219	

REMARKS

This receipt was generated by the automated BLM Collections and Billing System and is a paper representation of a portion of the official electronic record contained therein.

AMC 341924

ANNE COE

5776 E. FOREST STREET, APACHE JUNCTION, AZ 85219
480.982.0473 anne@annecoe.com < www.annecoe.com >

August 20, 2005

Bureau of Land Management
222 N. Central Ave
Phoenix, AZ 85004-2003

Please find enclosed my check for \$250 for the following mining claims:

AMC 341924 Mt. Union

AMC 341925 Spruce

ENTERED INTO COMPUTER
SEP 07 2005 *LB*

Sincerely,



Anne Coe

ARIZONA
STATE OFFICE
PHOENIX, ARIZONA

2005 AUG 23 P 2:21

RECEIVED
BUREAU OF
LAND MANAGEMENT

United States Department of the Interior
Bureau of Land Management
 BUSINESS & SUPPORT SVCS DIV
 222 N CENTRAL AVE
 PHOENIX, AZ 85004 -2203
 Phone: (602) 417-9200

Receipt

No: 1138135

Transaction #: 1177304		ENTERED INTO COMPUTER SEP 07 2005 <i>FB</i>
Date of Transaction: 08/26/2005		
CUSTOMER:	ANNE COE 5776 E FOREST ST APACHE JUNCTION, AZ 85219	

LINE #	QTY	DESCRIPTION	REMARKS	UNIT PRICE	TOTAL
1	1.00	LOCATABLE MINERALS / MINING CLAIMS- NOT NEW-UNADJUD, ONE AUTH NO. ONLY / MINING CLAIM MONEY RECEIVED (455) CASES: AMC341924/\$250.00	MAINT 2006 (2)	- n/a -	250.00
TOTAL:					\$250.00

PAYMENT INFORMATION			
1	AMOUNT:	\$250.00	POSTMARKED: 08/22/2005
	TYPE:	CHECK	RECEIVED: 08/23/2005
	CHECK NO:	0799	
	NAME:	COE, ANNE E 5776 E FOREST ST APACHE JUNCTION AZ 85219	

REMARKS

This receipt was generated by the automated BLM Collections and Billing System and is a paper representation of a portion of the official electronic record contained therein.

A N N E C O E

5775 E. Forest St., Apache Junction, AZ, (480)982-0473, anne@annecoe.com
www.annecoe.com

AMC 341924

August 26, 2004

Bureau of Land Management
222 N. Central Ave
Phoenix, AZ 85004-2203

Please find enclosed my check for \$250.00 for the following mining claims:

AMC 341924 Mt. Union
AMC 341925 Spruce

Sincerely,

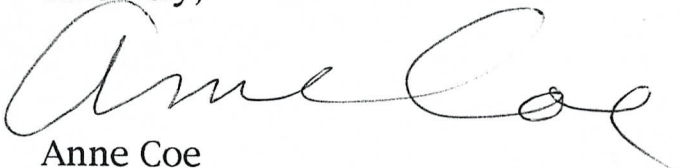

Anne Coe

RECEIVED
BUREAU OF
LAND MANAGEMENT
2004 SEP - 1 A 9:47
ARIZONA
STATE OFFICE
PHOENIX, ARIZONA

ENTERED INTO COMPUTER

10/13/04

United States Department of the Interior
Bureau of Land Management
 BUSINESS & SUPPORT SVCS DIV
 222 N CENTRAL AVE
 PHOENIX, AZ 85004 -2203
 Phone: (602) 417-9200

Receipt

No:

947170

Transaction #: 981615**Date of Transaction:** 09/07/2004

CUSTOMER: ANNE COE
 5776 E FOREST ST
 APACHE JUNCTION, AZ 85219

LINE #	QTY	DESCRIPTION	REMARKS	UNIT PRICE	TOTAL
1	1.00	LOCATABLE MINERALS / MINING CLAIMS-NOT NEW-UNADJUD, ONE AUTH NO. ONLY / MINING CLAIM MONEY RECEIVED (455) CASES: AMC341924/\$250.00	MAINT 2005 - 2	- n/a -	250.00
TOTAL:					\$250.00

PAYMENT INFORMATION

1	AMOUNT: \$250.00	POSTMARKED: 08/30/2004
	TYPE: CHECK	RECEIVED: 09/01/2004
	CHECK NO: 6768	
	NAME: COE, ANNE E 5776 E FOREST ST APACHE JUNCTION AZ 85219	

REMARKS

This receipt was generated by the automated BLM Collections and Billing System and is a paper representation of a portion of the official electronic record contained therein.

AMC 341924

ANNE COE
ARTIST/CONSERVATIONIST

5776 E. FOREST STREET, APACHE JUNCTION, AZ 85219 (480) 982-0473 email:aecoe@primenet.com

August 22, 2003

2 x \$100.00 = \$200.00
TCS

Bureau of Land Management
222 N. Central Ave.
Phoenix, AZ 85004-2203

Please find enclosed my check for \$200.00 for the following mining claims in Yavapai County.

AMC 341924 Mt. Union
AMC 341925 Spruce

Sincerely,

Anne Coe

RECEIVED
BUREAU OF
LAND MANAGEMENT
2003 AUG 26 A 11:17
ARIZONA
STATE OFFICE
PHOENIX, ARIZONA

9/16/03 TCS
ENTERED INTO COMPUTER

TCS

United States Department of the Interior
Bureau of Land Management
 BUSINESS & SUPPORT SVCS DIV
 222 N CENTRAL AVE
 PHOENIX, AZ 85004 -2203
 Phone: (602) 417-9200

Receipt	
No:	739499

Transaction #: 769030
Date of Transaction: 08/27/2003
CUSTOMER: ANNE COE 5776 E FOREST ST APACHE JUNCTION,AZ 85219

LINE #	QTY	DESCRIPTION	REMARKS	UNIT PRICE	TOTAL
1	1.00	LOCATABLE MINERALS / MINING CLAIMS-NOT NEW-UNADJUD,ONE AUTH NO. ONLY / MINING CLAIM MONEY RECEIVED (455) CASES: AMC341924/\$200.00	MAIN 2004 (2)	- n/a -	200.00
TOTAL:					\$200.00

PAYMENT INFORMATION		
1	AMOUNT: \$200.00	POSTMARKED: 08/25/2003
	TYPE: CHECK	RECEIVED: 08/26/2003
	CHECK NO: 0557	
	NAME: COE, ANNE E 5776 E FOREST ST APACHE JUNCTION AZ 85219	

REMARKS

This receipt was generated by the automated BLM Collections and Billing System and is a paper representation of a portion of the official electronic record contained therein.

ANNE COE

ARTIST/CONSERVATIONIST

5776 E. FOREST STREET, APACHE JUNCTION, AZ 85219 480/982-0473 aecoe@mindspring.com

August 25, 2002

Bureau of Land Management
222 N. Central Ave
Phoenix, AZ 85004-2203

Please find enclosed my check for \$200.00 for the following mining claims in Yavapai County.

AMC 341924	Mt. Union
AMC 341925	Spruce

Sincerely,

Anne Coe

2002 AUG 27 A 10:26
BUREAU OF LAND MANAGEMENT
PHOENIX, AZ 85004

ENTERED INTO COMPUTER

United States Department of the Interior
Bureau of Land Management
 BUSINESS & SUPPORT SVCS DIV
 222 N CENTRAL AVE
 PHOENIX, AZ 85004 -2203
 Phone: (602) 417-9200

Receipt	
No:	549263

Transaction #: 573977
Date of Transaction: 08/27/2002

CUSTOMER:	ANNE COE 5776 E FOREST ST APACHE JUNCTION, AZ 85219
------------------	---

LINE #	QTY	DESCRIPTION	REMARKS	UNIT PRICE	TOTAL
1	1.00	LOCATABLE MINERALS / MINING CLAIMS-NOT NEW-UNADJUD, ONE AUTH NO. ONLY / MINING CLAIM MONEY RECEIVED (455) CASES: AMC341924/\$200.00	MAINT 2003 (2)	- n/a -	200.00
TOTAL:					\$200.00

PAYMENT INFORMATION			
1	AMOUNT:	\$200.00	POSTMARKED: 08/26/2002
	TYPE:	CHECK	RECEIVED: 08/27/2002
	CHECK NO:	0428	
	NAME:	COE, ANNE E 5776 E FOREST ST APACHE JUNCTION AZ 85219	

REMARKS

This receipt was generated by the automated BLM Collections and Billing System and is a paper representation of a portion of the official electronic record contained therein.

Receipt No. 365758

LEAD FILE #'S _____

Trans No. 384360

341924 *do*
341924

AMC Number	Code	Amount
<u>341924-341925</u>	<u>482</u>	<u>200</u>
TOTAL:		<u>\$200</u>

AMC Number	Code	Amount
TOTAL:		\$

Date of Doc 8/27/01

Date Entered: DM 10/23/01

Date of Rec't 8/27/01

Date Verified: _____

Amount Rec'd \$200.00

Sent to Accts: 10/23/01

Amount Earned \$200.00

Date Earned: _____

- 480 POL
- 481 NOI
- 482 MAINT
- 396 TRANS
- 635 AMEND

NOTES: _____

ANNE COE

ARTIST/CONSERVATIONIST

5776 E. FOREST STREET, APACHE JUNCTION, AZ 85219 480/982- 0473 email: aecoe@primenet.com

August 17, 2001

Bureau of Land Management
222 N. Central Ave
Phoenix, A 85004-2203

To Whom It May Concern:

Please find my check enclosed for \$200.00 for the following mining claims for 2002.

AMC 341924 Mt Union

AMC 341925 Spruce

Sincerely,



Anne Coe

2001 AUG 27 A 10:15
BUREAU OF LAND MANAGEMENT

ENTERED INTO COMPUTER

DM 10/23/01

**United States Department of the Interior
Bureau of Land Management**
BUSINESS & SUPPORT SVCS DIV
222 N CENTRAL AVE
PHOENIX, AZ 85004 -2203
Phone: (602) 417-9200

Receipt	
No:	365758

Transaction #: 384360
Date of Transaction: 08/27/2001

CUSTOMER: ANNE COE
5776 E FOREST ST
APACHE JUNCTION, AZ 85219

LINE #	QTY	COMMODITY / SUBJECT / ACTION / PRODUCT	REMARKS	UNIT PRICE	TOTAL
1	1.00	LOCATABLE MINERALS / MINING CLAIMS-NOT NEW-UNADJUD, ONE AUTH NO. ONLY / MINING CLAIM MONEY RECEIVED (455)	MAINT 2002 (2)	- n/a -	\$200.00
TOTAL:					\$200.00

PAYMENT INFORMATION			
1	AMOUNT:	\$200.00	POSTMARKED: 08/24/2001
	TYPE:	CHECK	RECEIVED: 08/27/2001
	CHECK NO:	0264	
	NAME:	COE, ANNE E 5776 E FOREST ST APACHE JUNCTION AZ 85219	

REMARKS

PHONE: SEE DOC

CASE SERIAL NUMBER INFORMATION		
TRNS #	LINE #	CASES
384360	1	AMC341924/\$200.00

This receipt was generated by the automated BLM Collections and Billings System and is a paper representation of a portion of the official electronic record contained therein.

MAINTENANCE FEE PAYMENT

**\$100.00 MAINTENANCE FEE PAYMENT DUE ON OR BEFORE AUGUST 31, 19__
IN LIEU OF ASSESSMENT WORK FOR THE UPCOMING ASSESSMENT
YEAR BEGINNING SEPTEMBER 1 OF THE YEAR NOTED ABOVE.**

BUREAU OF LAND MANAGEMENT
ARIZONA STATE OFFICE
3707 NORTH 7TH STREET
PHOENIX, AZ 85014 (OR)
P.O. BOX 16563, PHOENIX, AZ 85011

COUNT: <u>2</u> \$ <u>200.00</u> INT: <u>sqm</u>
FOR OFFICIAL USE ONLY

THE CLAIMS ARE SITUATED IN YAVAPAI COUNTY, ARIZONA.

BLM SERIAL NUMBERS	NAMES OF CLAIMS OR SITES
A MC _____ THRU A MC _____	_____
COUNTY BOOK/DOCKET _____, PAGE(S) OR FEE NO(S) _____	_____
A MC _____ THRU A MC _____	_____
COUNTY BOOK/DOCKET _____, PAGE(S) OR FEE NO(S) _____	_____

(OR) IF NOT CONSECUTIVE NUMBERS LIST SEPARATELY BELOW:

BLM SERIAL NUMBERS	NAME OF CLAIMS/SITES	COUNTY BOOK/DOCKET & PAGE OR FEE NUMBER
A MC <u>34 19 24</u>	<u>Mt Union</u>	<u>3315 page 804</u>
A MC <u>34 19 25</u>	<u>Spruce</u>	<u>3315 page 806</u>
A MC _____	_____	_____
A MC _____	_____	_____
A MC _____	_____	_____
A MC _____	_____	_____
A MC _____	_____	_____
A MC _____	_____	_____
A MC _____	_____	_____
A MC _____	_____	_____
A MC _____	_____	_____

CLAIMANT'S NAME: Robert Howarth

ADDRESS: 5776 E. Forest CITY: Apache Jct STATE: AZ

CHECK HERE IF THIS IS A CHANGE OF ADDRESS PHONE: (480) 982-0973 ZIP: 85219

SIGNATURE: Robert Howarth
TO RECORD WITH THE COUNTY, ONE CLAIMANT OR THE AGENT MUST SIGN

LIST ALL ADDITIONAL OWNERS ON REVERSE SIDE OF THIS FORM

FOR OFFICIAL USE ONLY		
ENTERED INTO COMPUTER: <u>96.00</u>	<u>[Signature]</u>	SEP 07 2000
DATE	INITIALS	VERIFIED

TIME STAMP
 RECEIVED
 BUREAU OF
 LAND MANAGEMENT
 AUG 31 11 30 AM '00
 ARIZONA STATE OFFICE
 PHOENIX, ARIZONA

43 CFR 3833.0-5(e) (August 30, 1994) REQUIRES THAT THE NAMES OF ALL OF THE OWNERS AND THEIR CURRENT ADDRESSES SHALL BE IDENTIFIED ON ALL INSTRUMENTS REQUIRED TO BE RECORDED OR FILED BY THE REGULATIONS, 43 CFR SUBPART 3833.

CLAIMANT'S NAME: _____

ADDRESS: _____ CITY: _____ STATE: _____

CHECK HERE IF THIS IS CHANGE OF ADDRESS PHONE: () _____ ZIP: _____

CLAIMANT'S NAME: _____

ADDRESS: _____ CITY: _____ STATE: _____

CHECK HERE IF THIS IS CHANGE OF ADDRESS PHONE: () _____ ZIP: _____

CLAIMANT'S NAME: _____

ADDRESS: _____ CITY: _____ STATE: _____

CHECK HERE IF THIS IS CHANGE OF ADDRESS PHONE: () _____ ZIP: _____

CLAIMANT'S NAME: _____

ADDRESS: _____ CITY: _____ STATE: _____

CHECK HERE IF THIS IS CHANGE OF ADDRESS PHONE: () _____ ZIP: _____

CLAIMANT'S NAME: _____

ADDRESS: _____ CITY: _____ STATE: _____

CHECK HERE IF THIS IS CHANGE OF ADDRESS PHONE: () _____ ZIP: _____

CLAIMANT'S NAME: _____

ADDRESS: _____ CITY: _____ STATE: _____

CHECK HERE IF THIS IS CHANGE OF ADDRESS PHONE: () _____ ZIP: _____

CLAIMANT'S NAME: _____

ADDRESS: _____ CITY: _____ STATE: _____

CHECK HERE IF THIS IS CHANGE OF ADDRESS PHONE: () _____ ZIP: _____

United States Department of the Interior
Bureau of Land Management
 BUSINESS & SUPPORT SVCS DIV
 222 N CENTRAL AVE
 PHOENIX, AZ 85004 -2203
 Phone: (602) 417-9200

Receipt	
No:	181594

Transaction #: 194896
Date of Transaction: 08/31/2000

CUSTOMER: ROBERT HORVATH
 5776 E FOREST ST
 APACHE JUNCTION, AZ 85219

LINE #	QTY	COMMODITY / SUBJECT / ACTION / PRODUCT	REMARKS	UNIT PRICE	TOTAL
1	1	LOCATABLE MINERALS / MINING CLAIMS-ACCOUNTS/UNADJUDICATED / MINING CLAIM MONEY RECEIVED (455)	MAINT 2001 (2)	- n/a -	\$200.00
TOTAL:					\$200.00

PAYMENT INFORMATION			
1	AMOUNT:	\$200.00	POSTMARKED: 08/24/2000
	TYPE:	CHECK	RECEIVED: 08/31/2000
	CHECK NO:	6434	
	NAME:	COE, ANNIE E 5776 E FOREST ST APACHE JUNCTION AZ 85219	

REMARKS

PHONE #480-982-0473

CASE SERIAL NUMBER INFORMATION		
TRNS #	LINE #	CASES
194896	1	AMC341924

This receipt was generated by the automated BLM Collections and Billings System and is a paper representation of a portion of the official electronic record contained therein.

UNITED STATES
DEPARTMENT OF THE INTERIOR
BUREAU OF LAND MANAGEMENT

RECEIPT AND ACCOUNTING ADVICE

NO. 2296338 07

CD/AZ 08/25/99

Subject: CLAIM MAINTENANCE FEE 2000

2 10 13

200.00

Applicant:

ROBERT HORVATH
5776 E FOREST ST
APACHE JUNCTION AZ 85219

CK 6240

Remitter:

Assignor:

LEASE MANAGEMENT DATA NEW UPDATE PAYMENT

ORIGINAL SERIAL NO.	ASG.	TYPE	ST.	CTY.	FUND SYMBOL	ACRES/UNITS	RATE
AMC 341924 & 341925							

AMOUNT	ANV. DATE	EXP. DATE	BILL CYC.	S/C	DISTRICT	NEXT BILL	MISC. DATA	U of M	ACTUAL UNITS

ASSIGNMENT SERIAL NO.	ASG.	TYPE	ST.	CTY.	FUND SYMBOL	ACRES/UNITS	RATE

AMOUNT	ANV. DATE	EXP. DATE	BILL CYC.	S/C	DISTRICT	NEXT BILL	MISC. DATA	U of M	ACTUAL UNITS

APPLY REMITTANCE			
ACTION	FUND SYMBOL	CTY.	AMOUNT
FILING FEE			
RENTAL			
UNEARNED			
REFUND			
TOTAL			
AMOUNT DUE			

Remarks:

BY: _____ DATE: _____

Lease in Escrow?
 KGS? Of Interest?
 Auto Escalates? Operating Rights?
 Auto Renew? Operator
 Bond Filed?

FOR MMS USE ONLY

BILLEE	FOREST REFUGE
NUMBER	
OCS SECTION	
CODE	

MAINTENANCE FEE PAYMENT

\$100.00 MAINTENANCE FEE PAYMENT DUE ON OR BEFORE AUGUST 31, 1998
 IN LIEU OF ASSESSMENT WORK FOR THE UPCOMING ASSESSMENT
 YEAR BEGINNING SEPTEMBER 1 OF THE YEAR NOTED ABOVE.

BUREAU OF LAND MANAGEMENT
 ARIZONA STATE OFFICE
 222 NORTH CENTRAL AVENUE
 PHOENIX, AZ 85004

341924

COUNT: 2 \$ 200.00 INT: Jan FOR
 OFFICIAL USE ONLY

THE CLAIMS ARE SITUATED IN YAVAPAI COUNTY, ARIZONA.

BLM SERIAL NUMBERS	NAMES OF CLAIMS OR SITES
A MC _____ THRU A MC _____ COUNTY BOOK/DOCKET _____, PAGE(S) OR FEE NO(S) _____	
A MC _____ THRU A MC _____ COUNTY BOOK/DOCKET _____, PAGE(S) OR FEE NO(S) _____	

(OR) IF NOT CONSECUTIVE NUMBERS LIST SEPARATELY BELOW:

BLM SERIAL NUMBERS	NAME OF CLAIMS/SITES	COUNTY BOOK/DOCKET & PAGE OR FEE NUMBER
A MC <u>341924</u>	<u>MT. UNION</u>	<u>3315 PAGE 804</u>
A MC <u>341925</u>	<u>SPRUCE</u>	<u>3315 PAGE 806</u>
A MC _____	_____	_____
A MC _____	_____	_____
A MC _____	_____	_____
A MC _____	_____	_____
A MC _____	_____	_____
A MC _____	_____	_____
A MC _____	_____	_____
A MC _____	_____	_____
A MC _____	_____	_____
A MC _____	_____	_____
A MC _____	_____	_____
A MC _____	_____	_____

CLAIMANT'S NAME: ROBERT HORWATH

ADDRESS: 5776 E. FOREST CITY: APACHE JCT STATE: AZ ZIP: 85219

CHECK HERE IF THIS PHONE: (602) 982-0473
 IS A CHANGE OF ADDRESS

SIGNATURE: Robert Horwath
 TO RECORD WITH THE COUNTY, ONE CLAIMANT OR THE AGENT MUST SIGN

LIST ALL ADDITIONAL OWNERS ON REVERSE SIDE OF THIS FORM

FOR OFFICIAL USE ONLY

ENTERED INTO COMPUTER: 8/25/98 SB [Signature]
 DATE INITIALS VERIFIED

TIME STAMP

AUG 24 9 54 AM '98

BLM STATE OFFICE
 PHOENIX, ARIZONA

43 CFR 3833.0-5(e) (August 30, 1994) REQUIRES THAT THE NAMES OF ALL OF THE OWNERS AND THEIR CURRENT ADDRESSES SHALL BE IDENTIFIED ON ALL INSTRUMENTS REQUIRED TO BE RECORDED OR FILED BY THE REGULATIONS, 43 CFR SUBPART 3833.

CLAIMANT'S NAME: ANNE COE
ADDRESS: 5776 E. FOREST CITY: APACHE JCT STATE: AZ ZIP: 85219
 CHECK HERE IF THIS PHONE: (602) 982-0473
IS A CHANGE OF ADDRESS

CLAIMANT'S NAME: _____
ADDRESS: _____ CITY: _____ STATE: _____ ZIP: _____
 CHECK HERE IF THIS PHONE: ()
IS A CHANGE OF ADDRESS

CLAIMANT'S NAME: _____
ADDRESS: _____ CITY: _____ STATE: _____ ZIP: _____
 CHECK HERE IF THIS PHONE: ()
IS A CHANGE OF ADDRESS

CLAIMANT'S NAME: _____
ADDRESS: _____ CITY: _____ STATE: _____ ZIP: _____
 CHECK HERE IF THIS PHONE: ()
IS A CHANGE OF ADDRESS

CLAIMANT'S NAME: _____
ADDRESS: _____ CITY: _____ STATE: _____ ZIP: _____
 CHECK HERE IF THIS PHONE: ()
IS A CHANGE OF ADDRESS

CLAIMANT'S NAME: _____
ADDRESS: _____ CITY: _____ STATE: _____ ZIP: _____
 CHECK HERE IF THIS PHONE: ()
IS A CHANGE OF ADDRESS

CLAIMANT'S NAME: _____
ADDRESS: _____ CITY: _____ STATE: _____ ZIP: _____
 CHECK HERE IF THIS PHONE: ()
IS A CHANGE OF ADDRESS

CLAIMANT'S NAME: _____
ADDRESS: _____ CITY: _____ STATE: _____ ZIP: _____
 CHECK HERE IF THIS PHONE: ()
IS A CHANGE OF ADDRESS

UNITED STATES
DEPARTMENT OF THE INTERIOR
BUREAU OF LAND MANAGEMENT

RECEIPT AND ACCOUNTING ADVICE

NO. **2389563** 04
TC/AZ 08/24/98

Subject: CLAIM MAINTENANCE FEE 1999 - 2 2 13 13 200.00 ✓

Applicant:
ROBERT HORVATH
5776 E FOREST
APACHE JUNCTION AZ 85219

Remitter: CK 5851
602 982-0473

Assignor:

LEASE MANAGEMENT DATA NEW UPDATE PAYMENT

ORIGINAL SERIAL NO.	ASG.	TYPE	ST.	CTY.	FUND SYMBOL	ACRES/UNITS	RATE
AMC 341924-341925							

AMOUNT	ANV. DATE	EXP. DATE	BILL CYC.	S/C	DISTRICT	NEXT BILL	MISC. DATA	U of M	ACTUAL UNITS

ASSIGNMENT SERIAL NO.	ASG.	TYPE	ST.	CTY.	FUND SYMBOL	ACRES/UNITS	RATE

AMOUNT	ANV. DATE	EXP. DATE	BILL CYC.	S/C	DISTRICT	NEXT BILL	MISC. DATA	U of M	ACTUAL UNITS

APPLY REMITTANCE

ACTION	FUND SYMBOL	CTY.	AMOUNT
FILING FEE			
RENTAL			
UNEARNED			
REFUND			
TOTAL			
AMOUNT DUE			

Remarks:

BY: _____ DATE: _____

Lease in Escrow?
 KGS? Of Interest?
 Auto Escalates? Operating Rights?
 Auto Renew? Operator
 Bond Filed?

FOR MMS USE ONLY

BILLEE NUMBER	FOREST REFUGE
OCS SECTION	
CODE	

Amc
341924
RB

MAINTENANCE FEE PAYMENT

\$100.00 MAINTENANCE FEE PAYMENT DUE ON OR BEFORE AUGUST 31, 19 97
IN LIEU OF ASSESSMENT WORK FOR THE UPCOMING ASSESSMENT
YEAR BEGINNING SEPTEMBER 1 OF THE YEAR NOTED ABOVE.

BUREAU OF LAND MANAGEMENT
ARIZONA STATE OFFICE
222 NORTH CENTRAL AVENUE
PHOENIX, AZ 85004

COUNT: 1 \$200.00 INT: MC FOR
OFFICIAL USE ONLY

THE CLAIMS ARE SITUATED IN YAVAPAI COUNTY, ARIZONA.

BLM SERIAL NUMBERS

NAMES OF CLAIMS OR SITES

A MC _____ THRU A MC _____
COUNTY BOOK/DOCKET _____, PAGE(S) OR FEE NO(S) _____

A MC _____ THRU A MC _____
COUNTY BOOK/DOCKET _____, PAGE(S) OR FEE NO(S) _____

(OR) IF NOT CONSECUTIVE NUMBERS LIST SEPARATELY BELOW:

BLM SERIAL NUMBERS	NAME OF CLAIMS/SITES	COUNTY BOOK/DOCKET & PAGE OR FEE NUMBER
A MC <u>341924</u>	<u>MT. UNION</u>	<u>3315 PAGE 804</u>
A MC <u>341925</u>	<u>SPRUCE</u>	<u>3315 PAGE 806</u>
A MC _____	_____	_____
A MC _____	_____	_____
A MC _____	_____	_____
A MC _____	_____	_____
A MC _____	_____	_____
A MC _____	_____	_____
A MC _____	_____	_____
A MC _____	_____	_____
A MC _____	_____	_____
A MC _____	_____	_____

CLAIMANT'S NAME: ROBERT HORWATH

ADDRESS: 5776 E FOREST CITY: APACHE JCT STATE: AZ ZIP: 85219

CHECK HERE IF THIS PHONE: (602) 982-0473
IS A CHANGE OF ADDRESS

SIGNATURE: Robert Horwath
TO RECORD WITH THE COUNTY, ONE CLAIMANT OR THE AGENT MUST SIGN

LIST ALL ADDITIONAL OWNERS ON REVERSE SIDE OF THIS FORM

FOR OFFICIAL USE ONLY
ENTERED INTO COMPUTER: _____
DATE INITIALS VERIFIED

TIME STAMP
PHOENIX, ARIZONA
Aug 11 11 06 AM '97
RECEIVED
BLM AZ STATE OFFICE
ENTERED IN COMPUTER

RB 8/26/97

43 CFR 3833.0-5(e) (August 30, 1994) REQUIRES THAT THE NAMES OF ALL OF THE OWNERS AND THEIR CURRENT ADDRESSES SHALL BE IDENTIFIED ON ALL INSTRUMENTS REQUIRED TO BE RECORDED OR FILED BY THE REGULATIONS, 43 CFR SUBPART 3833.

CLAIMANT'S NAME: _____
ADDRESS: _____ CITY: _____ STATE: _____ ZIP: _____
 CHECK HERE IF THIS PHONE: () _____
IS A CHANGE OF ADDRESS

CLAIMANT'S NAME: _____
ADDRESS: _____ CITY: _____ STATE: _____ ZIP: _____
 CHECK HERE IF THIS PHONE: () _____
IS A CHANGE OF ADDRESS

CLAIMANT'S NAME: _____
ADDRESS: _____ CITY: _____ STATE: _____ ZIP: _____
 CHECK HERE IF THIS PHONE: () _____
IS A CHANGE OF ADDRESS

CLAIMANT'S NAME: _____
ADDRESS: _____ CITY: _____ STATE: _____ ZIP: _____
 CHECK HERE IF THIS PHONE: () _____
IS A CHANGE OF ADDRESS

CLAIMANT'S NAME: _____
ADDRESS: _____ CITY: _____ STATE: _____ ZIP: _____
 CHECK HERE IF THIS PHONE: () _____
IS A CHANGE OF ADDRESS

CLAIMANT'S NAME: _____
ADDRESS: _____ CITY: _____ STATE: _____ ZIP: _____
 CHECK HERE IF THIS PHONE: () _____
IS A CHANGE OF ADDRESS

CLAIMANT'S NAME: _____
ADDRESS: _____ CITY: _____ STATE: _____ ZIP: _____
 CHECK HERE IF THIS PHONE: () _____
IS A CHANGE OF ADDRESS

CLAIMANT'S NAME: _____
ADDRESS: _____ CITY: _____ STATE: _____ ZIP: _____
 CHECK HERE IF THIS PHONE: () _____
IS A CHANGE OF ADDRESS

UNITED STATES
DEPARTMENT OF THE INTERIOR
BUREAU OF LAND MANAGEMENT

RECEIPT AND ACCOUNTING ADVICE

NO. 2315229 04

TC/AZ

08/11/97

Subject: CLAIM MAINTENANCE FEE 1998 - 2

2 4 13

200.00

Applicant:

ANNE E COE
5776 E FOREST ST
APACHE JUNCTION AZ 85219

CK 5339

Remitter:

Assignor:

LEASE MANAGEMENT DATA NEW UPDATE PAYMENT

ORIGINAL SERIAL NO.	ASG.	TYPE	ST.	CTY.	FUND SYMBOL	ACRES/UNITS	RATE
AMC 341924-341925							

AMOUNT	ANV. DATE	EXP. DATE	BILL CYC.	S/C	DISTRICT	NEXT BILL	MISC. DATA	U of M	ACTUAL UNITS

ASSIGNMENT SERIAL NO.	ASG.	TYPE	ST.	CTY.	FUND SYMBOL	ACRES/UNITS	RATE

AMOUNT	ANV. DATE	EXP. DATE	BILL CYC.	S/C	DISTRICT	NEXT BILL	MISC. DATA	U of M	ACTUAL UNITS

APPLY REMITTANCE

ACTION	FUND SYMBOL	CTY.	AMOUNT
FILING FEE			
RENTAL			
UNEARNED			
REFUND			
TOTAL			
AMOUNT DUE			

Remarks:

341924-341925 (2)
ERS

BY:

DATE:

- Lease in Escrow?
- KGS?
- Auto Escalates?
- Auto Renew?

- Of Interest?
- Operating Rights?
- Operator
- Bond Filed?

FOR MMS USE ONLY

BILLEE NUMBER	FOREST REFUGE
OCS SECTION CODE	

NOTICE!!

These documents have been scanned!

Do not place un-scanned documents beneath this notice!

Do not remove this notice from this file!

GPO Jacket No. 560-102
Print Order 61540
Rise Business Services, LLC
Job=AZ15 7/15/2019



Box Number= AZ15159



Claim Begin-End: AMC341924-AMC341925

5 Miscellaneous



AZ15159-2

AMC341757-AMC342788

**NO
DOCUMENTS
FOUND**

NO DOCUMENTS FOUND
NO DOCUMENTS FOUND

NOTICE!!

These documents have been scanned!

Do not place un-scanned documents beneath this notice!

Do not remove this notice from this file!

GPO Jacket No. 560-102
Print Order 61540
Rise Business Services, LLC
Job=AZ15 7/15/2019



Box Number= AZ15159



Claim Begin-End: AMC341924-AMC341925

6 Location Notices-Amendments and Supporting Documents



AZ15159-2

AMC341757-AMC342788

AM 5/23/97

MINING CLAIM STATUS REPORT

Lead Serial No. A MC 341924 THROUGH A MC 341925

No. of Lode Claims 2

STATUS CHECKED BY JB
Enter Action Code 669

No. of Placer Claims _____

MTP CHECKED JB (Need original)
(Reduced Size Copy Enclosed)

No. of Association Placer
(Not Enough Locators Send Form Ltr.) _____

ORCA GEO CHECKED JB
(Copy Enclosed)

No. of Mill Sites _____

No. of Tunnel Sites _____

Timely Filed YES NO

WILDERNESS (WA) AREA CHECKED N/A

Service Charge Correct YES NO
(This is Curable)

WHICH WA _____

Location Fee Correct YES NO

Maintenance Fee Correct YES NO

Amount Paid \$ 270.00

Shortage \$ 0 Overage \$ 0

Over-the-Counter Mail _____

Township(s) T. 12N

Range(s) R. 01W

Section(s) S. 6

GENERAL JURISDICTION OF: BLM _____ (or) WHICH NATIONAL FOREST Prescott

Enter Code 880 On Split Estate Land (Show Type of Patent - SX, PX, SRHE etc)
N/A

Enter Code 267 For Stockraising Homestead When Proper Notice Has Been Filed
N/A

STATUS.

CLAIMS PARTIALLY VOID: Private Minerals _____ Withdrawn _____ Other _____

CLAIMS VOID: Private Minerals _____ Withdrawn _____ Other _____

ADD: DATE RECEIVED, ACTION CODE 482, IN REMARKS: 1995, 1996, 1997, 1998

SPECIAL INSTRUCTIONS FOR DATA INPUT: _____

COMMENTS _____

When recorded, mail to:

Name: _____

Address: _____

City/State/Zip Code: _____

RECEIVED
BLM
ARIZONA STATE OFFICE
NOV 12 1 58 PM '96

Space above this line for Recorder's use

NOTICE OF MINING CLAIM

1. TYPE OF NOTICE: Location Amendment Relocation
 2. TYPE OF CLAIM: Placer Lode Millsite Tunnelsite
 3. The name and address of the Locator is
 Name: ROBERT HORWATH & ANNE COE
 Address: 5776 E FOREST ST.
 City/State/Zip Code: APACHE JCT, AZ. 85219
 4. The name of the claim is MT. UNION.
 5. The date of the location is 9-1-96
 6. The claim is 1500 feet long and 600 feet wide. The distance from the location monument to each end of the claim is 1500 feet in a NORTH direction and 600 feet in a EAST. direction.
 7. The general course of the claim is from the SOUTH to the NORTH
 8. The location of the claim is in Section 6, Township 12 N, Range 1 W
- _____ Base and Meridian,
HASSAYAMPA Mining District, YAVAPAI County,
 State of ARIZONA
9. If amending or relocating, the previous claim name was _____
 _____ recorded in Docket(Book) _____ page(s) _____,
 _____ Mining District, _____ County,
 State of _____
 10. The location of the claim with reference to a natural object or permanent monument is
462 FEET SOUTH OF NATIONAL FOREST MARKER ON CORNER 4
OF HONDO MINING CLAIM (MS2588) ALONG THE BORDER
OF THE HONDO CLAIM.

Dated: 11/12/96

Robert Horwath / Anne Coe
 Signature
5776 E. FOREST ST.
 Address
APACHE JCT, AZ 85219
 City/State/Zip

A
M
C
2
1
9
7
4

MAP OF MINING CLAIM LOC ON

1. The name of the claim is MT. UNION ;
2. The 2(SW) corner of the claim is 462 feet in a SOUTH direction to a survey monument or permanent natural object described as NATIONAL FOREST SURVEY MARKER ON CORNER 4(NW) OF HONDO MINING CLAIM. ;
3. The type of location monument is 3 FT STONE ;
The type of corner end monuments are STONE PILE ;
4. The bearing and distance between the corners of the claim are beginning at the SW corner of the claim, 600 feet in a EAST direction to the SE corner, then 1500 feet in a NORTH direction to the NE corner, then 600 feet in a WEST direction to the NW corner, then 1500 feet in a SOUTH direction to the point of beginning.

MAP

One inch = One thousand feet

North Arrow



ONE MILE

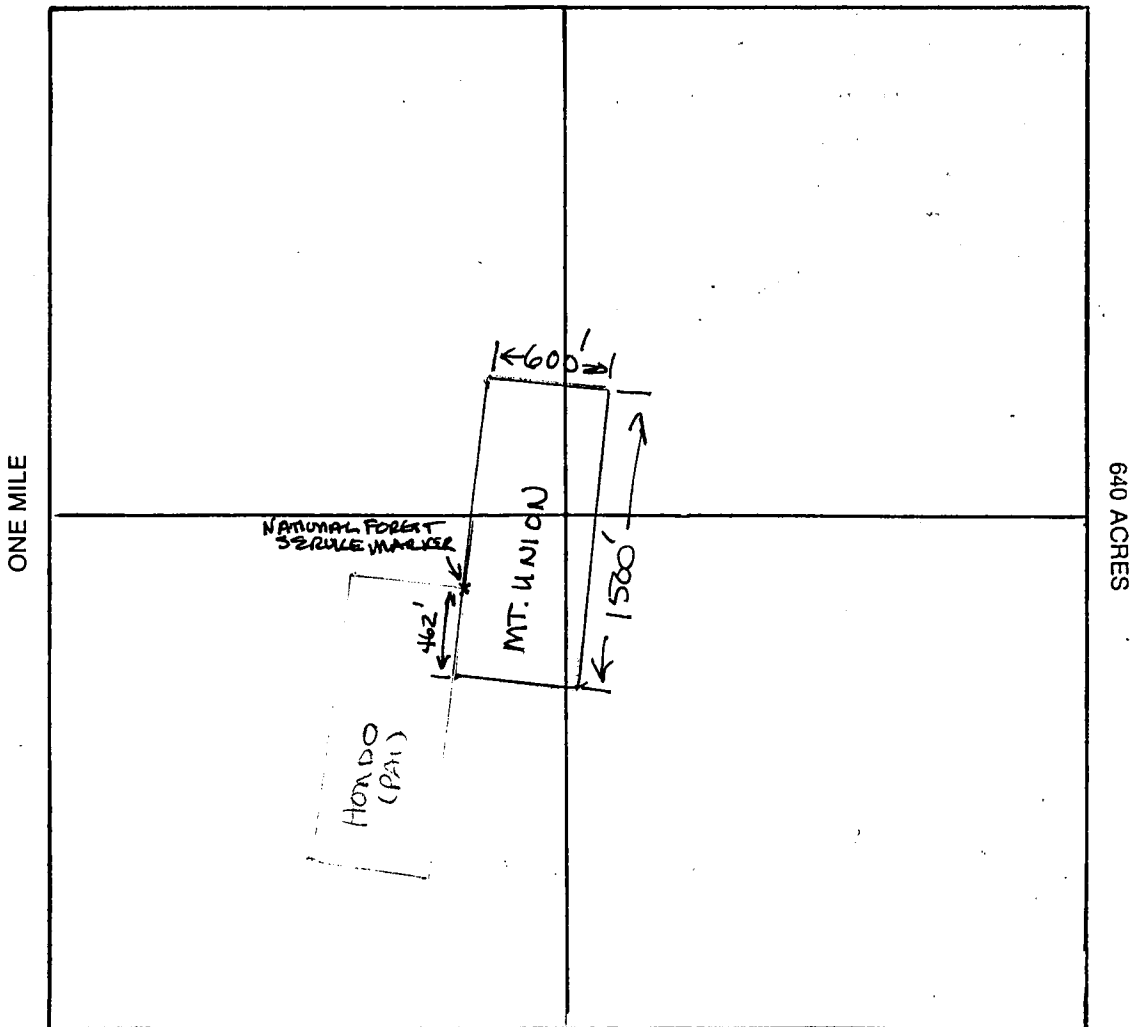

Section 6 (Center) Range 1W Township 12N

Base and Meridian.

Dated: 11/12/96 Robert Howarth / Anne Cole
Signature

When recorded, mail to:

Name: _____

Address: _____

City/State/Zip Code: _____

RECEIVED
ARIZONA DEPARTMENT OF REVENUE
NOV 12 1 58 PM '96

Space above this line for Recorder's use

NOTICE OF MINING CLAIM

- 1. TYPE OF NOTICE: Location Amendment Relocation
- 2. TYPE OF CLAIM: Placer Lode Millsite Tunnelsite

3. The name and address of the Locator is

Name: ROBERT HOWARTH & ANNE COE

Address: 5776 E. FOREST ST.

City/State/Zip Code: APACHE JCT, AZ 85219

4. The name of the claim is SPRUCE

5. The date of the location is 9-1-96

6. The claim is 1500 feet long and 600 feet wide. The distance from the location monument to each end of the claim is 1500 feet in a SOUTH direction and 600 feet in a EAST direction.

7. The general course of the claim is from the NORTH to the SOUTH

8. The location of the claim is in Section 6, Township 12N, Range 1W

Base and Meridian,

HASSAYAMA Mining District, YAVAPAI County, State of ARIZONA

9. If amending or relocating, the previous claim name was _____

_____ recorded in Docket(Book) _____ page(s) _____ Mining District, _____ County, State of _____

10. The location of the claim with reference to a natural object or permanent monument is _____

462 ft. SOUTH OF NATIONAL FOREST SERVICE MARKER AT CORNER 4 OF HONDO MINING CLAIM (MS 2588) ALONG THE BORDER OF THE HONDO CLAIM

Dated: 11/12/96

Robert Howarth / Anne Coe
Signature

5776 E. FOREST ST.
Address

APACHE JCT, AZ 85219
City/State/Zip

MAP OF MINING CLAIM LOC ON

- The name of the claim is SPRUCE ;
- The NW corner of the claim is 462 feet in a NORTH direction to a survey monument or permanent natural object described as NATIONAL FOREST SURVEY MARKER ON THE CORNER 4 (NE) OF HONDOMING CLAIM ;
- The type of location monument is 3 FT STONE ;
The type of corner end monuments are STONE PILE ;
- The bearing and distance between the corners of the claim are beginning at the NW corner of the claim, 600 feet in a EAST direction to the NE corner, then 1500 feet in a SOUTHWEST direction to the SE corner, then 600 feet in a WEST direction to the SW corner, then 1500 feet in a NORTH direction to the point of beginning.

MAP

One inch = One thousand feet

North Arrow



ONE MILE

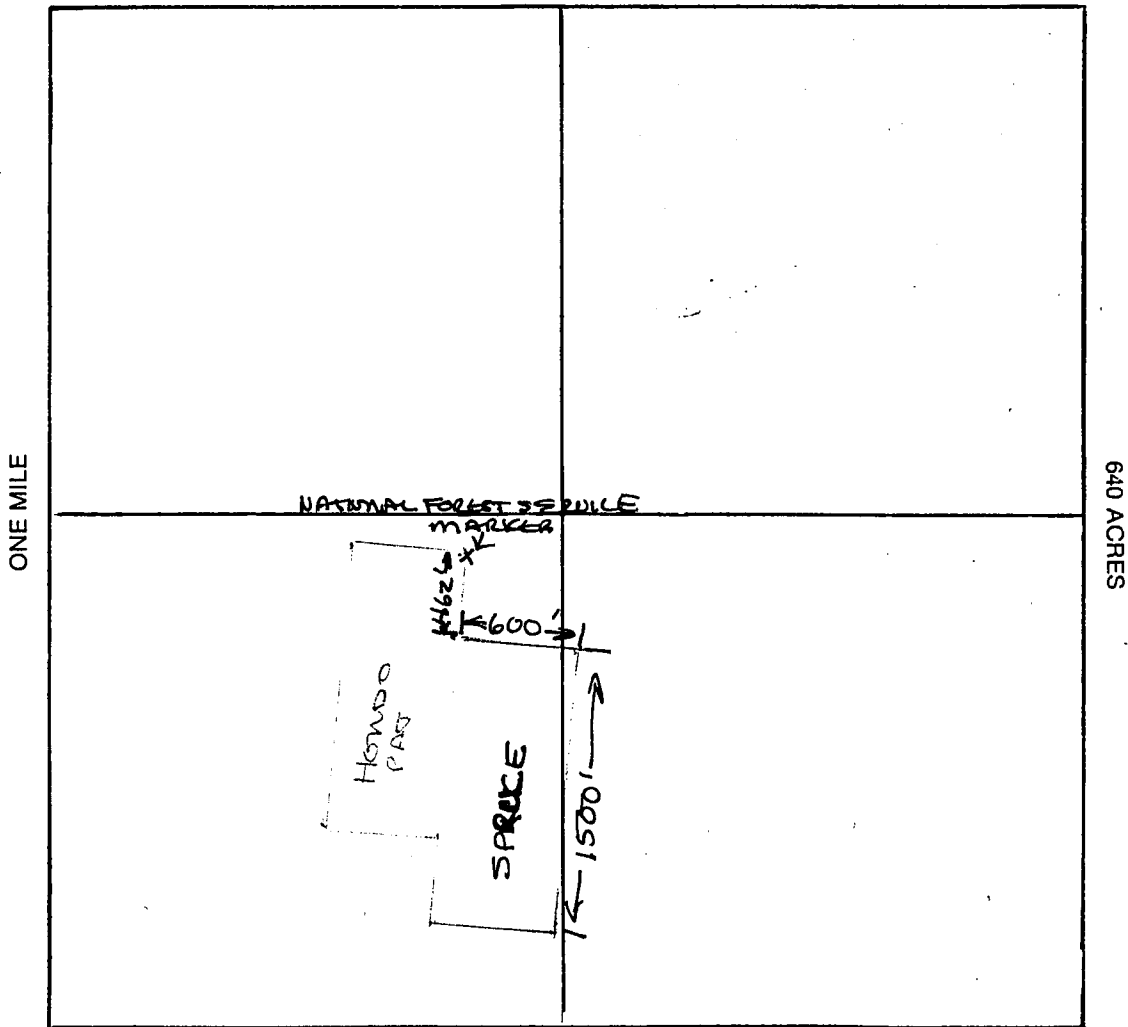

Section 6 (SW) Range 1W Township 12N

Base and Meridian.

Dated: 11/12/96 Robert Howarth / Anne Coe Signature

SERIAL REGISTER PAGE

GEO STATE: ARIZONA SERIAL NO: AZA 24110FD
 CASE TYPE: 220200 EX-FS SEC 206, FLPMA
 LEGAL REF: EX-FS SEC 206, FLPMA 10/21/1976 AC COMMODITY: EXCHANGE

NAME	ADDRESS	% INTRST INTEREST
GOSWICK CATTLE CO IN	BOX 157 HUMBOLT, AZ 86329-	100.00000 PATENTEE

M_	TOWN	RANGE	SEC	SUBDIVISION	SURFACE MGMT AGENCY
14	12.ON	1.0E	005	LOT 9,10	
			006	LOT 20,21	

***** TOTAL ACRES: 75.540 *****

ACTN DATE	CODE	ACTION	ACTION REMARKS	PEND ACT
10/30/1989	387	CASE ESTABLISHED	ACCTS	SM
10/30/1989	543	SEGREGATION (MINERAL)	LOC;	JRB
10/30/1989	544	SEGREGATION (SURFACE)		JRB
10/30/1989	552	LAND SEGREGATED		
12/01/1989	600	RECORDS NOTED		SD
06/27/1990	074	INFORMATION SENT	MIN RPT TO FS	JG
08/12/1991	271	PATENT ISSUED - NUMBERED	02-91-0020;	
08/12/1991	372	SEGREGATION TERMINATED		JG
08/28/1991	968	CASE ACTION COMPLETED		LW
10/21/1991	600	RECORDS NOTED	PATENT	SD
01/27/1992	149	CASE RECEIVED	LANDS/LW	SD
08/14/1992	149	CASE RECEIVED	LANDS/LW	SD

STATE	ENTITY	ACRES
	PHOENIX DISTRICT, ARIZONA	75.540
ARIZONA	YAVAPAI COUNTY, ARIZONA	75.540
	PRESCOTT NF, FOREST SERVICE	75.540

CASE DISPOSITION: 08/12/1991 AUTHORIZED

SERIAL REGISTER PAGE

GEO STATE: ARIZONA SERIAL NO: AZA 24110PT
CASE TYPE: 220200 EX-FS SEC 206, FLPMA
LEGAL REF: EX-FS SEC 206, FLPMA 10/21/1976 AC COMMODITY: EXCHANGE

NAME	ADDRESS	% INTRST INTEREST
FS REGION 3	517 GOLD AVE SW ALBUQUERQUE, NM 87102-	100.00000 ADMIN MGT ENTITY

M_	TOWN	RANGE	SEC	SUBDIVISION	SURFACE MGMT AGENCY
14	12.0N	1.0E	006	M&B	
14	12.0N	1.0W	004	MS 913	
14	12.2N	1.0W	024	PART MS 3401	
			025	PART MS 3401	

***** TOTAL ACRES: 80.590 *****

ACTN DATE	CODE	ACTION	ACTION REMARKS	PEND ACT
10/30/1989	387	CASE ESTABLISHED	ACCTS	SM
12/06/1989	074	INFORMATION SENT	APLN ACKNOWLEDGED	JG
07/15/1991	865	TITLE ACCEPTED BY US		LW
08/28/1991	968	CASE ACTION COMPLETED		LW
10/21/1991	600	RECORDS NOTED	WARRANTY DEED	SD
01/27/1992	149	CASE RECEIVED	LANDS/LW	SD
08/14/1992	149	CASE RECEIVED	LANDS/LW	SD

STATE	ENTITY	ACRES
ARIZONA	PHOENIX DISTRICT, ARIZONA	80.590
	YAVAPAI COUNTY, ARIZONA	80.590
	PRESCOTT NF, FOREST SERVICE	80.590

CASE DISPOSITION: 07/15/1991 AUTHORIZED

GEOGRAPHIC STATE: ARIZONA MERIDIAN: 14 TOWNSHIP: 12-0N RANGE: 1-0W

SEC	SUBDIVISION	MTR X-REFERENCE	NUMBER/TYPER/DISPOSITION/ACRES	PROPRIETOR/INTEREST/RELATIONSHIP
18	SESW		CASE: AZA 002735	FS PRESCOTT NF 0.00000% SURFACE JURIS
18	LOT 6		TYPE: 232170 WDL-FS MISCELLANEOU	FS REGION 3 0.00000% SURFACE JURIS
			DISP: AUTHORIZED 05/12/69	USDA 100.00000% HOLDING AGENC
			ACRS: 00087.180	
008	POR OF NE		CASE: AZA 019102	CHAMBERS EDMUND S 0.00000% APPLICANT
			TYPE: 386300 MINERAL PATENT PLAC	
			DISP: CLOSED 08/30/85	
			ACRS: 00090.000	
004	MS 913	14 12-0N 1-0E	CASE: AZA 024110PT	FS REGION 3 100.00000% ADMIN MGT ENT
		14 12-2N 1-0W	TYPE: 220200 EX-FS SEC 206, FLPM	
			DISP: AUTHORIZED 07/15/91	
			ACRS: 00080.590	
	6 NW	14 12-0N 2-0W	CASE: AZPHX 0086907	AZ PUBLIC SERVICE CO 100.00000% HOLDER
		14 12-2N 2-0W	TYPE: 289100 ROW-FOREST LAND	
			DISP: AUTHORIZED 08/11/52	
			ACRS: 00001.510	

TOWNSHIP 12 NORTH RANGE 1 EAST OF THE GILA AND SALT RIVER MERIDIAN, ARIZONA

YAVAPAI COUNTY

STATUS OF PUBLIC DOMAIN
LAND AND MINERAL TITLES

**MTP
SUPPL Sec 5,6,35,36**

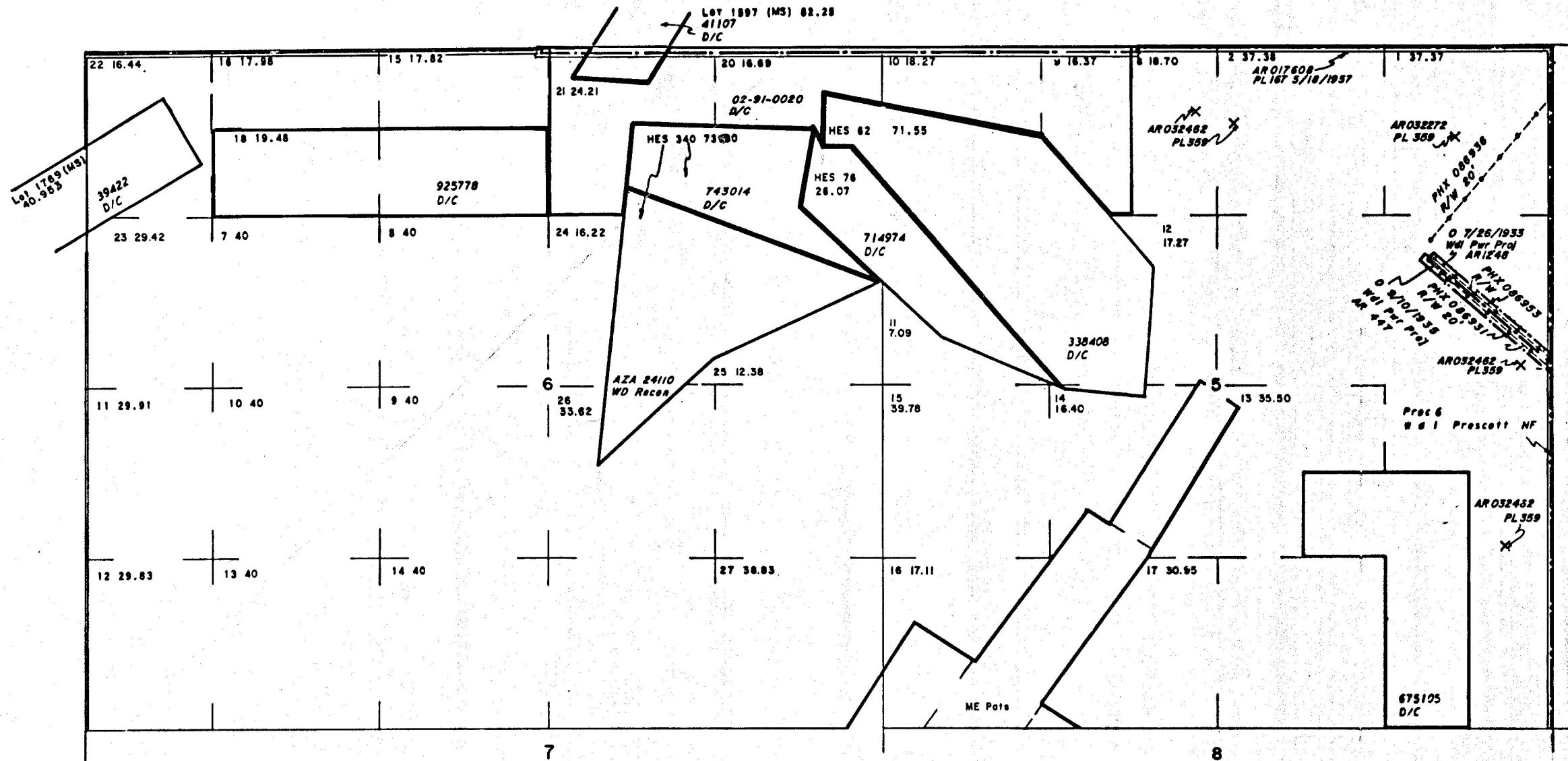

INDEX TO SEGREGATED TRACTS				
RESURVEY	ORIGINAL SURVEY			
TRACT NO	T	R	SEC	SUBDIVISION

FOR ORDERS EFFECTING DISPOSAL OR USE OF UNIDENTIFIED LANDS WITHDRAWN FOR CLASSIFICATION, MINERALS, WATER AND/OR OTHER PUBLIC PURPOSES, REFER TO INDEX OF MISCELLANEOUS DOCUMENTS.

DIST. NO. 2

MDS 13 ME

14 NW

15 SE

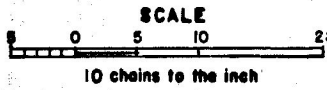
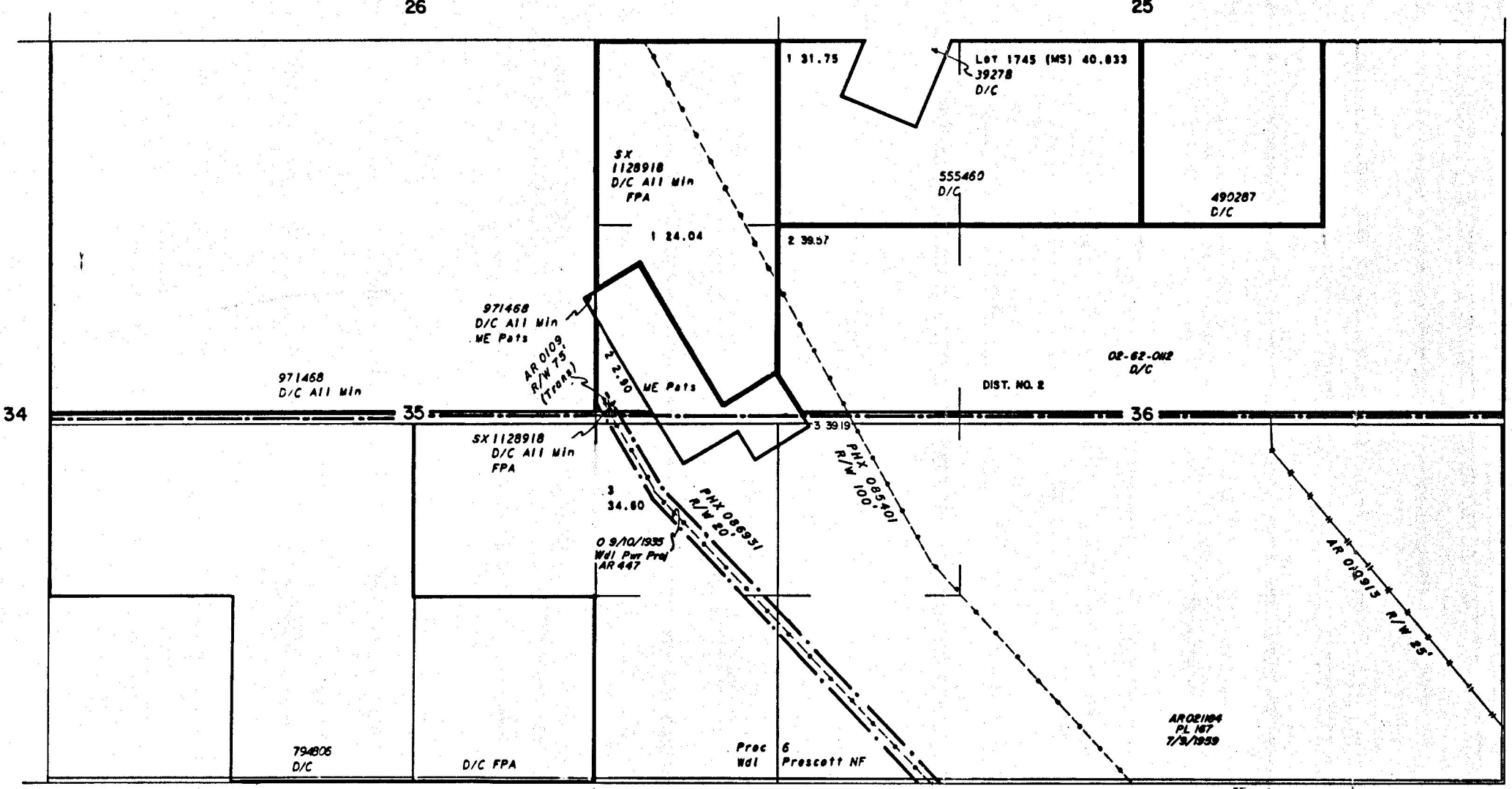

WARNING STATEMENT
This plat is the Bureau's Record of Title, and should be used only as a graphic display of the township survey data. Records hereon do not reflect title changes which may have been effected by lateral movements of rivers or other bodies of water. Refer to the cadastral surveys for official survey information.

CURRENT TO	BY

T. 12N
R. 1E